

## "BRAKE DISC BOLT (YAMAHA type)" NEWLY RELEASED !!

### K·PIT

## ROTOR BOLT NEWLY RELEASED!



Genuine - quality M8 steel bolt newly released

● SIZE (mm)

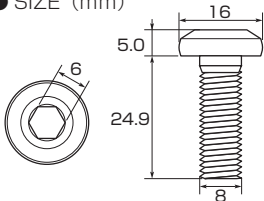

**ROTOR BOLT COMPATIBILITY**



\* USE LOW-STRENGTH SCREW LOCK AGENT. BE CAREFUL NOT TO APPLY TOO MUCH.

## ROTOR BOLT (YAMAHA type)

QTY	CODE	PRICE
1	<a href="#">70-500-73001</a>	¥260
3	<a href="#">70-500-73101</a>	¥720

- REPLACEMENT ● STEEL ● P1.25
- COMPATIBLE GENUINE NUMBER : 90109-082G4 \*1, 90109-083G4, 90109-084F7 \*1, 90109-085A4 \*1, 90109-08718, 90111-08057, 90111-08084, 90111-08815, 90149-08814

### APPLICATION

- FRONT / REAR OF FOLLOWING MODEL  
CYGNUS X/-SR (SEA5J/SED8J), MAJESTY S (SG28J/SG52J), MAJESTY 250 (SG01J/SG03J), MAXAM (SG17J/SG21J), YZF-R25/MT-25 (RG10J/RG43J/RG74J), YZF-R3/MT-03 (RH07J/RH13), XJR400/-R (4HM/RH02J), TMAX (SJ04J), XVS950CR BOLT /-R/-C (VN04J/VN09J), VMAX1200 (3TU), XJR1200 /R/1300 (4KG/RO1J/RO3J) etc.
- FRONT OF FOLLOWING MODEL  
CYGNUS X/-SR (SE12J/SE44J), MAJESTY 250 (4HC), DRAGSTAR 400/C (4TR/VH01J), TMAX 530/560 (SJ12J/SJ15J/SJ19J) etc.

\* 1 Usable though genuine color is different \* Make sure of the actual size before purchase \* Not reusable

### K·CON

## CONNECTOR SET (110 type) in BLACK NEWLY RELEASED!

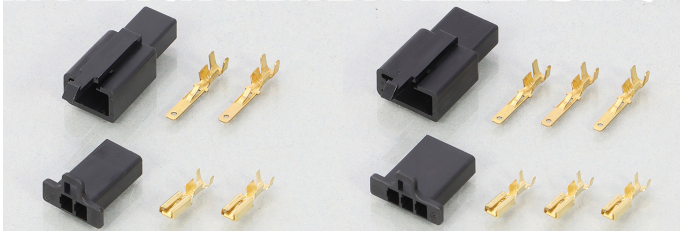

A set of 110 type connector (in black) & terminals.

## CONNECTOR SET (110 type / BLACK)

TYPE	CODE	PRICE
2P	<a href="#">0900-755-02200</a>	¥320
3P	<a href="#">0900-755-02201</a>	¥360

● COUPLER : BLACK

\* Flat terminal set for 110 type connector (0900-755-01010)

### K·TOUR

## USB POWER SUPPLY KIT for DAX125 NEWLY RELEASED!



To prepare battery supply for mobile phone and etc. Just insert between couplers! No wiring mods required!

## MUST FOR RIDERS!



Places lower left of the meter

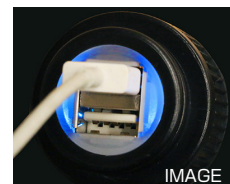

LED (BLUE) is lit, when the power is on.

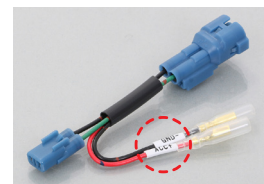

Kitaco original "mark tube" is included.  
ACC ⊕ · · · ACCESSORY  
GND ⊖ · · · GROUND

### DAX125

## USB POWER SUPPLY KIT

CODE	PRICE
<a href="#">80-757-13200</a>	¥4,800

- USB : 2 PORT ● INPUT / OUTPUT : DC12V / DC5V : MAX 2A (WHEN USING 1 PORT) ● ACC ⊕ · · · POWER ACCESSORY / GND ⊖ · · · GROUND ● FROM : OPTION COUPLER INSIDE THE HEADLIGHT CASE ● STAY : STEEL WITH BLACK ● DRIP-PROOF\*
- LED (BLUE) BUILT-IN ● EXCLUSIVE HARNESS INCL.
- KITACO ORIGINAL TUBE INCL.

APPLICATION DAX125 (JB04)

- \* For 12V model
- \* Not completely waterproof. Do not use it when washing vehicle or rain. Use rubber cap when not using.
- \* Condensation might happen inside the cap according to the weather. Do not install this near the engine and remove the dew with air duster / vacuum if happened.
- \* Not for high current accessories such as amplifier & compressor etc.