



K • TOUR

MONKEY 125 (JB02/03)

USB POWER SUPPLY FOR MONKEY 125 (JB02/03) NEWLY RELEASED!!



JB02

JB03

To get the battery to charge smart phone & etc. Just insert between coupler to get battery!

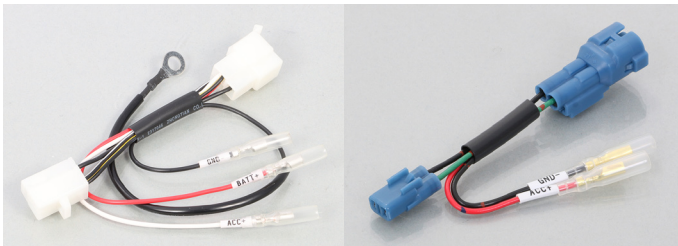

HARNESS FOR JB02

HARNESS FOR JB03



HANDLE BRACE WITH MOBILE HOLDER



USB POWER SUPPLY KIT

TYPE	CODE	PRICE
JB02	80-757-13000	¥4,800
JB03	80-757-13010	¥5,000

- COUPLER-ON ● STAY : STEEL WITH BLACK ● TIGHTENS WITH SPEEDOMETER STAY ● EXCLUSIVE HARNESS INCLUDED
- FROM : INSIDE THE HEADLIGHT CASE ● INTERFACE : USB x 2 PORT ● INPUT / OUTPUT : DC12V / DC5V : MAX 2A (WHEN 1 PORT USE) ● ACC ⊕ . . . ACCESSORY / GND ⊖ . . . GROUND
- DRIP-PROOF * ● LED BUILT-IN (BLUE) ● MARK TUBE INCLUDED (KITACO ORIGINAL)

APPLICATION MONKEY 125 (JB02/03)

- * This is for 12V model
- * Not completely waterproof. Do not use it when washing vehicle or rain. Use rubber cap when not using.
- * Condensation might happen inside the cap according to the weather. Do not install this near the engine and remove the dew with air duster / vacuum if happened.
- * Not for high current accessories such as amplifier & compressor and so on.

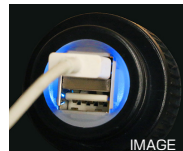

The LED (BLUE) is lit when the power is turned on.

OPTION

HANDLE BRACE

PRICE : ¥8,000

- BLACK : 619-9010050
- SILVER : 619-9010060
- GOLD : 619-9010070



K • CON Pro

OIL NIPPLE NEWLY RELEASED!



L-shaped nipple used for manifold oil/pressure nipple

● SIZE (mm)

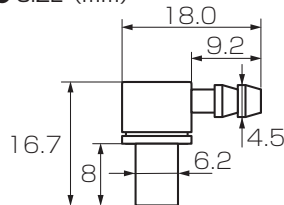

OIL NIPPLE (L TYPE)

CODE	PRICE
0901-990-00010	¥900

● REPLACEMENT ● STEEL ● SURFACE TREATMENT : UNI-CHROMATE ● SOLD EACH

- * Drive-in type nipples are finished and driven into holes that are - 0.05 to - 0.1 mm smaller than the outer diameter.
- * Uses adhesive for metals according to the material and what to use (three bond 1303N etc.).