

SUPER OIL COOLER KIT for KLX110

No. 360-4022100

Application: KLX110 FNo. LX110A-000001~

● Please read and understand the instruction before installing.

ATTENTIONS (MUST READ)

- This is a part to cool down the engine oil which got heated by combustion and the cooling part which prevents from heat trouble and performance degradation.
- We are not responsible for damages and accidents caused by assembling mistake and improper setting. Those are all drivers responsibility.
- Follow the instructions and attach correctly.
- Do not modify the way which is not listed, or it will cause damage and trouble.
- Please ask mechanic for assembling and setting.
- Please ask a specialist at specialty shop if you do not understand the role of the surrounding parts.
- Refer to the KAWASAKI service manual for each vehicle when attaching.
- Bolts and nuts may get loosen by engine vibration.
- Please check and make sure that each part of bolts and nuts are not loose before running.
- This part is only for KLX110, do not use for other models.



This instruction sheet is for the person who has basic knowledge for maintenance. Do not operate if you do not have skill and knowledge.



As for engine oil, during engine operation and after operation are extremely hot. Please start working after the oil cools down enough. (it may be hot even when the surface is cool)



FLAMMABLES

Inflammable high gasoline is used during operation. The use of products causing fire or smoke is strictly prohibited.



As for cylinder, crankcase, exhaust pipe, etc., during engine operation and after operation are extremely hot. Do not touch carelessly.

● KIT CONTENTS (Refer to the number while installing)

	NAME	No.	PCS		NAME	No.	PCS
1	UNION BOLT (RED) M8 X 1.25	771-0900910	2	11	6.5 X 16 X 1.6mm WASHER	090-0907006	4
2	10mm BANJO ALUMINUM WASHER	771-0500999	5	12	M6 X 25 CAP BOLT	060-0500025	2
3	UNION NIPPLE (BLUE)	990-0900900	3	13	6mm NUT	001-0500006	1
4	SEALING WASHER (8 X 14 X 1)	092-0501008	2	14	6mm SPRING WASHER	091-0500006	1
5	OIL COOLER CONDENSER	360-0500100	1	15	6mm PLAIN WASHER	090-0900006	1
6	UNION BOLT (RED) M10 X 1.25	771-0900900	1	16	HOSE 100cm	991-0000100	1
7	NIPPLE (BLUE) M10 X 1.25	990-0900800	1	17	STAINLESS BAND No. 16 (10-16)	995-0500016	4
8	CONDENSER BRACKET	330-4022102	1				
9	GROMMET COLLAR (2 X 7.5 X 7)	093-0900003	2				
10	GROMMET (7.5 X 9 X 7.5)	752-9998099	2				

INSTALLING

Drain the engine oil after you make sure the engine is cool enough and start installing. Tighten the bolts and nuts in the tightening torque as it is listed. Drain the oil from the oil pipe which is connected to the right side engine or the crankcase.

INSTALLING CONDENSER

1. Remove left side shroud and air cleaner housing which is attached to the frame.
 2. Install the condenser by stock bolts to the place where the air cleaner housing were attached.
 3. Cut the oil hose properly, connect each outlet to condenser and tighten the end of the hose by stainless band.
- ※ Make sure not to connect the oil hose touching the exhaust muffler and engines. Bundle the hoses by tie band. Set the hose properly by adjusting the union nipple's direction, and then tighten the union nipple and oil nipple in the specified torque.
4. Pour about 75-100cc of engine oil (condenser capacity). Idle the engine for a few minutes to osmore the oil in the oil filter. Stop the engine and wait a few minutes till the oil level is stabilized.
 - ※ Do not rev-up the engine quickly when starting the engine. Time-lag may occur to lube the engine oil by installing oil cooler.
 5. Make sure the engine oil is between upper level and lower level by the oil level window. Engine oil filling amount : 1.0L (When removing or installing filter)
 6. Start the engine. Run after you make sure there is no oil leakage or jolting.

※ Reuse stock parts for the parts which are not included.
Change with new parts if they have blem, fatigue or wear.

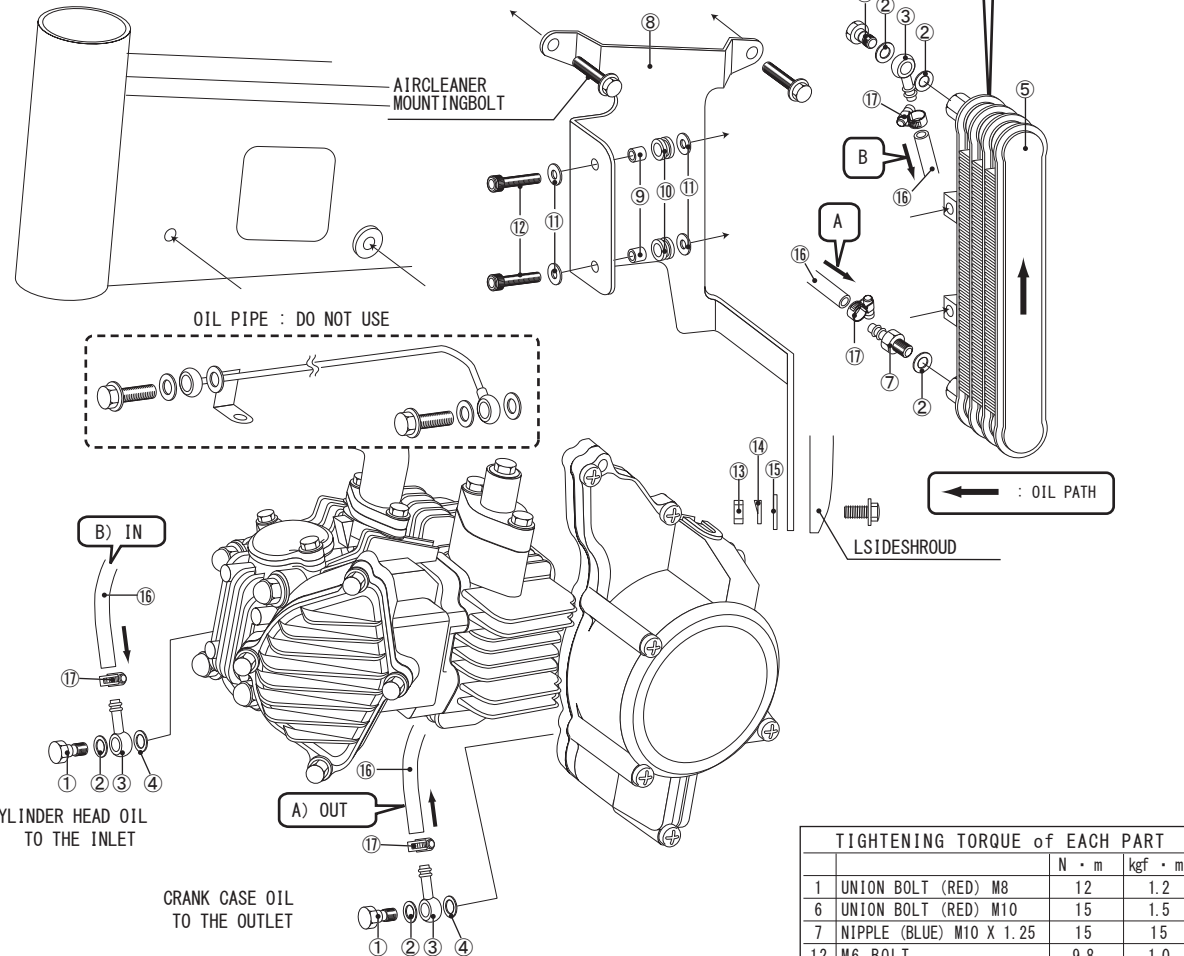

TIGHTENING TORQUE of EACH PART			
		N · m	kgf · m
1	UNION BOLT (RED) M8	12	1.2
6	UNION BOLT (RED) M10	15	1.5
7	NIPPLE (BLUE) M10 X 1.25	15	1.5
12	M6 BOLT	9.8	1.0