

INITIAL ADJUSTER SET / SPRING REPLACEMENT TOOL No,1/2

CODE : 502-1432100

APPLICATION : MONKEY125 (JB02 / 03) / DAX125 (JB04) / GROM (JC61 / 75 / 92) GROM (HRC)

ATTENTION! : This is not a disassemble according to HONDA service manual. Recommend to ask to a professional with specialized knowledge.

- Thank you for purchasing Kitaco product. Read and understand the instruction before installing.
- Each specified tools and rubber seal SET may required to install this product.

ATTENTION (MUST READ)

- Refer to the manufacturer service manual when installation.
- This product is for racing use. Note that racing products are not covered under warranty.
- We are not responsible for violation of law or damages and accidents caused by assembling mistake and improper setting.
- Follow this instruction sheet. Do not modify the way which is not listed or it will cause damage and trouble.
- Please ask authorized mechanic for assembling and setting. Ask a specialist at specialty shop if you do not understand the role of the surrounding parts.
- Bolts and nuts may get loosen by engine vibration. Make sure not to loosen any bolts and nuts before driving.
- This product is designed and made exclusive for application models, do not use other models.



This sheet is intended for the person who has basic knowledge for maintenance. Do not operate if you do not have skill and knowledge.



It is extremely high heat after using firearms. Do not touch it carelessly. Please start operate with protection.

▼REQUIRED GENERAL & SPECIFIED TOOL

Stock tool are conformed to the service manual. This is not a limit depending on how to install.

	NAME	CODE	PURPOSE
SPECIFIED TOOL 1	REPLACEMENT TOOL	674-1432500	Fixing tool for assemble / disassemble inner fork, etc
-	VICE	-	Fixing tool for replacement tool
-	SCREW LOCK	-	Fixing lower fork boots
-	GAS BURNER / TORCH	-	When melting screw lock

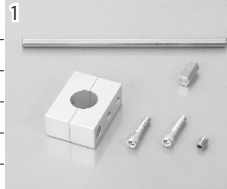

MAINTENANCE INFORMATION

- OIL SURFACE (FULL FLEXION) : (STOCK SPECIFIED VALUE) 75mm
- INITIAL ADJUSTABLE RANGE : 0~12mm (1ROTATE=1mm) RIGHT SCREW ADJUST TOOL : MINUS DRIVER

PACKING LIST

FIGURE	NAME	CODE	QTY	REMARK
1	INITIAL ADJUSTER	-	x2	
2	O RING (1.9x21.0)	500-1432102	x2	If it is deformed or broke, change to new one.
3	O RING (2.4x23.3)	500-1432103	x2	

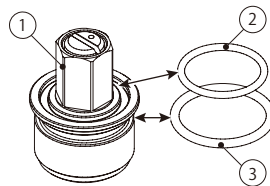

(OPTION) REPLACEMENT TOOL PACKING LIST

FIGURE	NAME	CODE	QTY	REMARK
1	HOLLOW SET M10	004-1432001	x1	Rotation stop pin
2	CAP BOLT M8x40	080-0500040	x2	
3	FRONT FORK CLAMP	674-1432501	x2	
4	HEXAGONAL PRISM	674-1432502	x1	
5	ROUND BAR M12	674-1432503	x1	

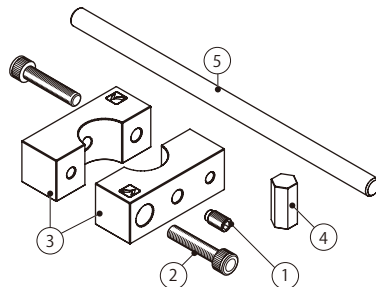

HOW TO REMOVE

※ Refer to the manufacturer service manual when installation.

- 1 Remove top cap and fork bolt. Drain all of the fork oil. Refer to the service manual.



- 2 Stretch the fork until find the orifice hole.
- ※ Oil might splash from orifice if oil remains. Recommend to roll it up by soft cloth, etc. [Fig.02]

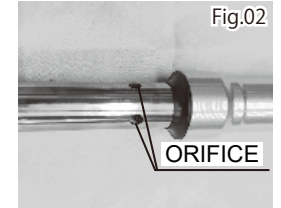

- 3 Ready specified tool1 replacement tool. Adjust rotate stop pin (pops out a little) [Fig.03]

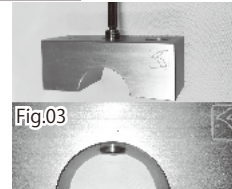

- 4 Fix replacement tool rotate stop pin to inner fork orifice hole. When fixing, tighten M8 bolts that attached to tool evenly, do not over tighten. [Fig.04]

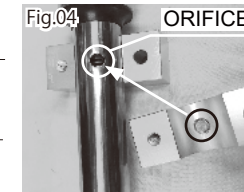

- 5 Sand replacement tool attached to fork firmly by the vice on vice stand. (Be careful of sanding direction)

※ Recommend to protect by soft cloth, etc not to scratch outer tube. [Fig.05]



Fig.05

- 6 Burn all around the fork boots (around 2 min) evenly by gas burner to burn screw lock.

※ Paint color might change.

※ **Be careful of burning!** Be careful of not to spread the flames to rolled soft cloth, etc.



*Burning time by gas burner is around 2-3 min. Fork boots color might be changed because of burning. Please understand.

INITIAL ADJUSTER SET / SPRING REPLACEMENT TOOL No,2/2	
CODE : 502-1432100	
APPLICATION : MONKEY125 (JB02 / 03) / DAX125 (JB04) / GROM (JC61 / 75 / 92) GROM (HRC)	
ATTENTION! : This is not a disassemble according to HONDA service manual. Recommend to ask to a professional with specialized knowledge.	

HOW TO INSTALL

7 Insert $\Phi 12$ round bar attached to tool to axle shaft hole, turn it to clockwise (reverse thread) to loosen fork boots. (Fix firmly by vice and recommend to operate with 2 people.)

※ Be careful of burning! If it is not loosen, burn again.

8 Loosen until fork boots rotates lightly, then pull up to remove. [Fig.08]

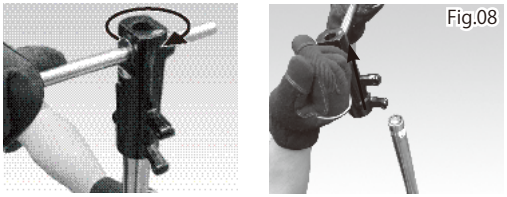

9 Loosen inner fork cap that appear after removed fork boots by 14mm hexagon prism attached to replacement tool to counter clockwise (right screw) and remove it. [Fig.09]

※ ATTENTION! When removing fork cap, spring might jump out.



10-1 Do not use stock inner fork cap and washer. (Please keep them safe because there is no replacement parts due to not disassemble structure.)

10-2 After cool down, if change to the Kitaco spring, please check the direction.

※ Recommend to install Kitaco spring identification color to upward (fork boots side).

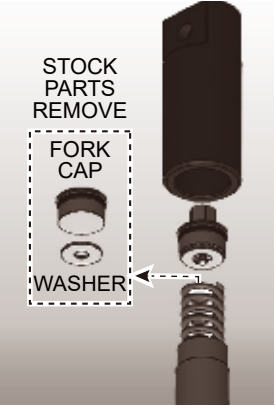

12 Install initial adjuster and tighten closewise.

TORQUE : 30N · m

※ Please use hexagonal hole tool. 12 point hole not usable. It might cause of strip.

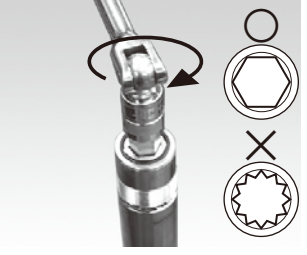

11 Install initial adjuster 2 pcs O ring to groove as same as stock. [Fig.11]

※ If Oring deformed or broken, change to new one.

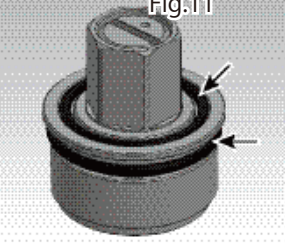

13 Remove old screw lock and apply new one around screw part evenly and thinly.

※ Be careful of too much!

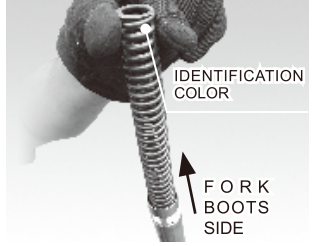
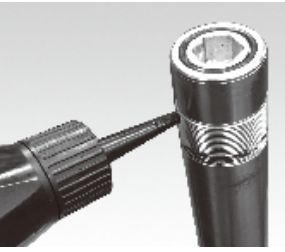

14 Install fork boots to inner fork. Insert $\Phi 12$ round bar attached to tool to axle shaft hole. Rotate to counter clockwise (reverse thread) to tighten boots. [Fig.14]

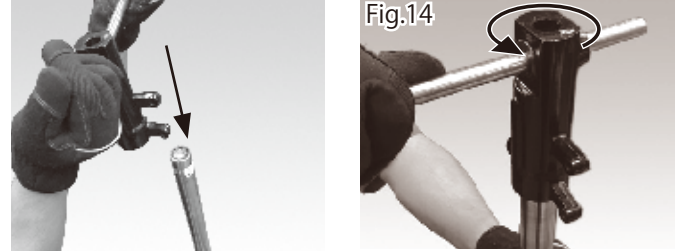

15 Remove fork from vice stand. Remove replacement tool.

16 Refer to the service manual or Kitaco spring data to pour fork oil, then adjust oil surface. Tighten fork bolt.

● OIL SURFACE : STOCK SPECIFIED VALUE 75mm (FULL FLEXION)

● HOW TO ADJUST INITIAL

ADJUSTABLE RANGE : 0~12mm (1ROTATE=1mm) RIGHT SCREW
Adjust adjuster rod with minus driver.

*Removing / installing axle shaft is required to adjust initial.

