

KITACO SHOCK ABSORBER (W type)

APPLICATION : PCX (JF28) CODE : 520-1426000 / 520-1426030

● Sold in pairs ● Length : 310 mm (same as stock)

● Read and understand the instruction before installing.

ATTENTIONS (MUST READ)

- Ask a mechanic or a specialist at a specialty shop for assembling and setting if you do not understand the role of the surrounding parts and so on.
- We are not responsible, for damages and accidents caused by assembling mistake, misuse and improper setting.
- Ride with care after installation, as controllability is different from stock shock.
- Refer to the HONDA service manual for each vehicle when installing.
- Bolts and nuts may get loosen by engine vibration. Make sure to check that each part of bolts and nuts are not loose before running.
- Do not modify the way which is not listed or it will cause damage and trouble.
- Please contact a mechanic nearby immediately when you find something unusual.

REMOVING PLASTICS (Make sure to follow HONDA service manual, as Kitaco instruction is just for reference)

REMOVING CENTER COVER

Be careful not to break pawls.

Pull body cover backwards

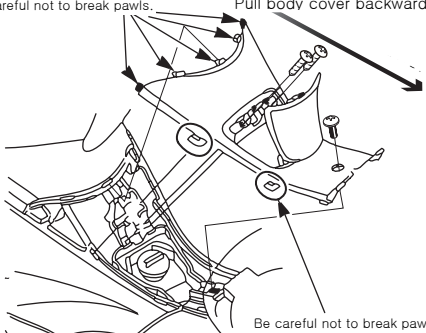

HOW TO INSTALL

※ Exchange to new parts if "reuse" parts has scratches, blem and wear.

- 1) Secure the motorcycle body, by placing the maintenance stand.
 - 2) Remove plastics such as body cover and luggage box, accordingly (Make sure to refer to HONDA Service manual when removing plastics)
 - 3) Remove stock rear shock, install Kitaco rear shock.
- ※ Install upper / lower mounting bolts (nuts) with designated torque.
UPPER NUT : 34N · m (3.5kgf · m) / LOWER BOLT : 27N · m (2.8kgf · m)
- 4) Adjust each part, making sure that the rear shock is stable before riding.

ADJUSTING PRELOAD

(Right and left adjustment should be the same level.)

Adjust the preload position, by loosening lock nut. Fasten the lock nut by pin spanner for sure after adjustment.

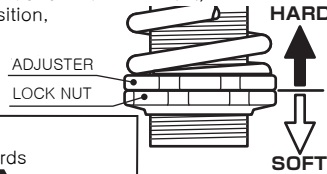

REMOVING BODY COVER/LUGGAGE BOX

Be careful not to break pawls.

Pull body cover backwards

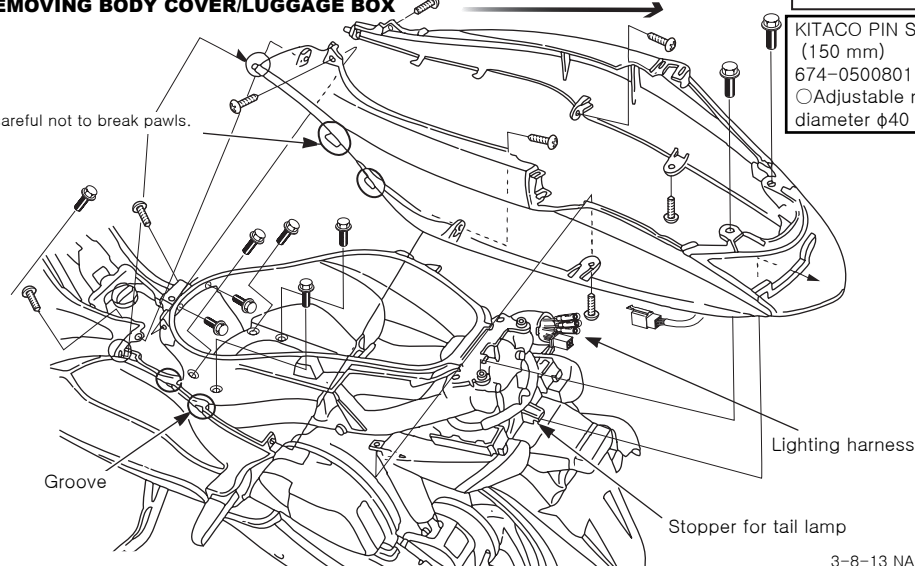

KITACO PIN SPANNER
(150 mm)
674-0500801
○ Adjustable nut
diameter φ40 ~ 60

130611

3-8-13 NAGATA
HIGASHI-OSAKA,
OSAKA, 577-0015,
JAPAN



KITACO SHOCK ABSORBER (W type)

APPLICATION : PCX (JF28) CODE : 520-1426000 / 520-1426030

● Sold in pairs ● Length : 310 mm (same as stock)

● Read and understand the instruction before installing.

ATTENTIONS (MUST READ)

- Ask a mechanic or a specialist at a specialty shop for assembling and setting if you do not understand the role of the surrounding parts and so on.
- We are not responsible, for damages and accidents caused by assembling mistake, misuse and improper setting.
- Ride with care after installation, as controllability is different from stock shock.
- Refer to the HONDA service manual for each vehicle when installing.
- Bolts and nuts may get loosen by engine vibration. Make sure to check that each part of bolts and nuts are not loose before running.
- Do not modify the way which is not listed or it will cause damage and trouble.
- Please contact a mechanic nearby immediately when you find something unusual.

REMOVING PLASTICS (Make sure to follow HONDA service manual, as Kitaco instruction is just for reference)

REMOVING CENTER COVER

Be careful not to break pawls.

Pull body cover backwards

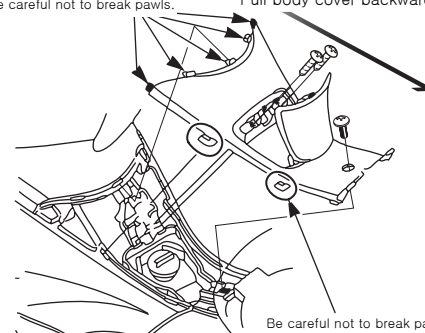

HOW TO INSTALL

※ Exchange to new parts if "reuse" parts has scratches, blem and wear.

- 1) Secure the motorcycle body, by placing the maintenance stand.
 - 2) Remove plastics such as body cover and luggage box, accordingly (Make sure to refer to HONDA Service manual when removing plastics)
 - 3) Remove stock rear shock, install Kitaco rear shock.
- ※ Install upper / lower mounting bolts (nuts) with designated torque.
UPPER NUT : 34N · m (3.5kgf · m) / LOWER BOLT : 27N · m (2.8kgf · m)
- 4) Adjust each part, making sure that the rear shock is stable before riding.

ADJUSTING PRELOAD

(Right and left adjustment should be the same level.)

Adjust the preload position, by loosening lock nut. Fasten the lock nut by pin spanner for sure after adjustment.

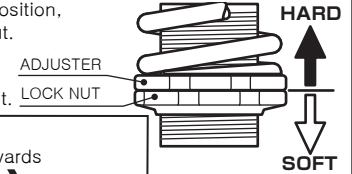

REMOVING BODY COVER/LUGGAGE BOX

Be careful not to break pawls.

Pull body cover backwards

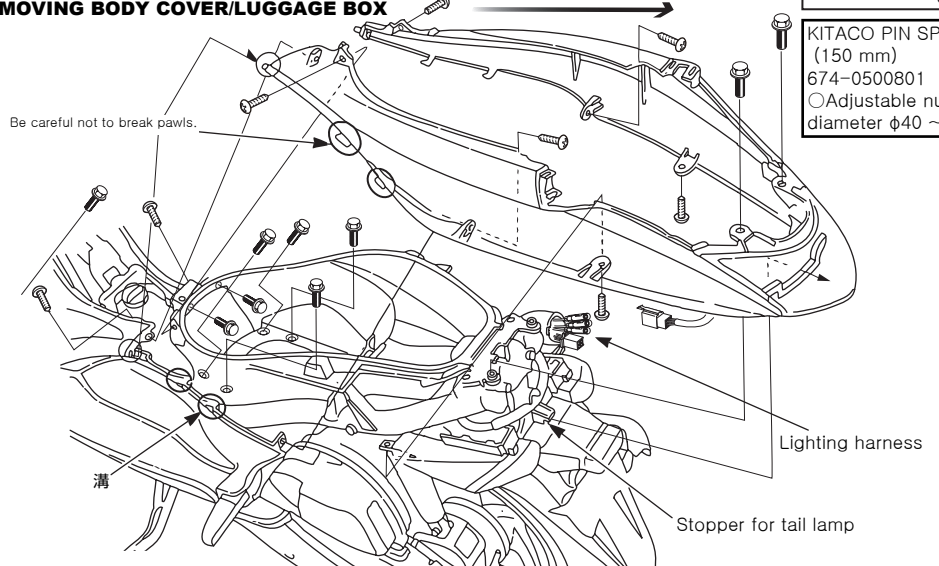

KITACO PIN SPANNER
(150 mm)
674-0500801
○ Adjustable nut
diameter φ40 ~ 60

130611

3-8-13 NAGATA
HIGASHI-OSAKA,
OSAKA, 577-0015,
JAPAN

