

SIDE STAND HS-149 for TACT	
CODE	656-1010149
APPLICATION	TACT (AF51)

Thank you for purchasing Kitaco product. Read and understand the instruction before installing.

ATTENTION (MUST READ)

- ▲ Pay attention to below to install side stand. Assembling mistake and improper setting may cause of trouble and accident.
- We are not responsible for violation of law or damages and accidents caused by assembling mistake and improper setting.
- Please ask authorized mechanic for assembling and setting. Ask a specialist at specialty shop if you do not understand the role of the surrounding parts.
- This product is designed and made exclusive for application models, do not use other models.
- The vehicle height is changed because of changing rear shock, etc may cause of falling because of stand degree. Please install with stock condition.
- After installation, move side stand back and forth, check the strage position and positon to stable vehicle.
- Do not shake or jump on the vehicle with using side stand. It might cause of breaking side stand, surrounding parts and accident.
- Do not over weight. It causes of falling.
- Bolts and nuts may get loosen by engine vibration. Make sure not to loosen any bolts and nuts before driving.
- Please give this instruction sheet when you sell to someone.



This instruction sheet is for who has basic maintenance knowledge. Do not operate if you do not have any skills and knowledge.



Do not modify the way which is not listed or it will cause damage and trouble.

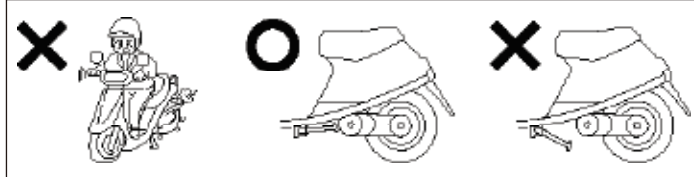

Do not start engine with using side stand. It might cause of jump out the vehicle and falling. Please storage side stand before riding.

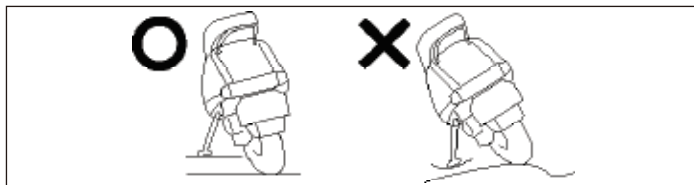

Do not use side stand on soft mud, bumpy road, etc. Check the side stand on the flat hard road to not falling before using side stand.

ILLUSTRATION 1

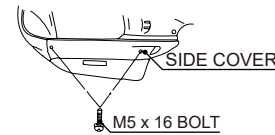

1. Remove M5 x 16 bolt from left side cover to remove it.

ILLUSTRATION 4

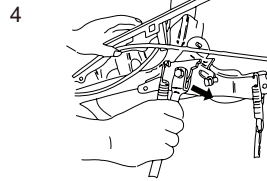

4. Insert side stand main unit to floated flange bolt. Route cable to outside.

ILLUSTRATION 7

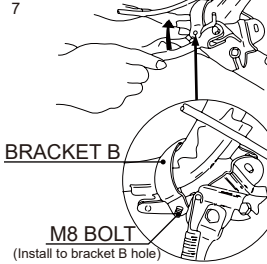

6. Lift the side stand main unit, insert M8 bolt to bracket B hole, tighten stand main unit and bracket B temporarily together with M8 x 30 bolt.

ILLUSTRATION 10

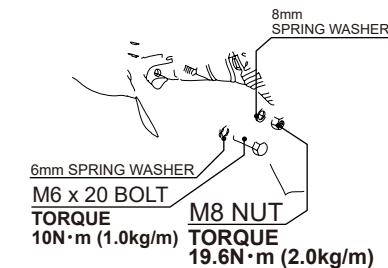

PACKING LIST	STAND MAIN UNIT	×1	BRACKET B	×1	BRACKET C	×1
	M8 x 30 BOLT	×1	M8 NUT	×1	8mm SPRING WASHER	×1
	M6 x 20 BOLT	×1	6mm SPRING WASHER	×1	BRAKE CABLE BRACKET D	×1
	CUT OUT STICKER	×1	HAND SAW	×1		

ILLUSTRATION 2

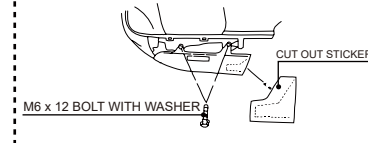

2. Remove M6 x 12 bolt with washer and left side under cover. Attach the cut out sticker. Cut the under cover along dotted line with handsaw or cutter knife.

ILLUSTRATION 5

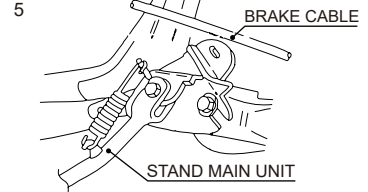
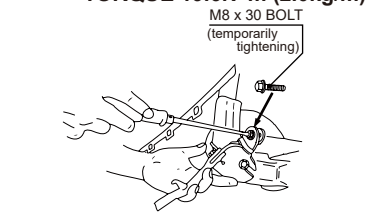

ILLUSTRATION 8 TORQUE 19.6N·m (2.0kg/m)



7. Install bracket C.

ILLUSTRATION 11



PACKING LIST	STAND MAIN UNIT	×1	BRACKET B	×1	BRACKET C	×1
	M8 x 30 BOLT	×1	M8 NUT	×1	8mm SPRING WASHER	×1
	M6 x 20 BOLT	×1	6mm SPRING WASHER	×1	BRAKE CABLE BRACKET D	×1
	CUT OUT STICKER	×1	HAND SAW	×1		

ILLUSTRATION 3 (Nut on vehicle right side)

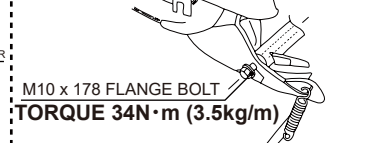

3. Loosen frame nut (opposite side of illustration) from vehicle right side. Float M10 x 178 flange bolt around 8mm from vehicle left side.

ILLUSTRATION 6

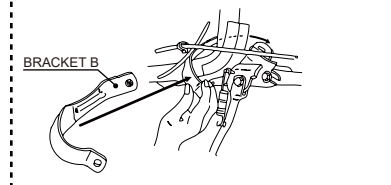

5. Place bracket B to back side of the frame.

ILLUSTRATION 9

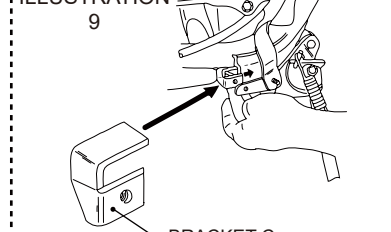

7. Install bracket C.

ILLUSTRATION 11

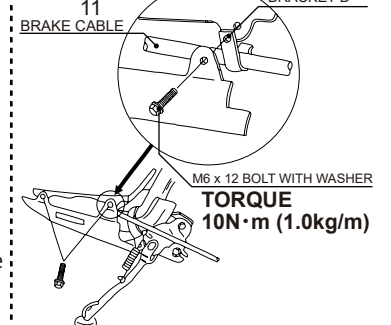

9. Tighten brake cable bracket D and under cowl together.
10. Put the removed parts back.