

## AERO VISOR

CODE	CLEAR : 670-0230000	SMOKE : 670-0230100
APPLICATION	JOG125 (BKR)	

Thank you for purchasing Kitaco product. Read and understand the instruction before installing.

### ATTENTION (MUST READ)

- This product is designed and made exclusive for application models, do not use other models. Do not modify the way which is not listed or it will cause damage and trouble.
- We are not responsible for violation of law or damages and accidents caused by assembling mistake and improper setting.
- Please ask authorized mechanic for assembling and setting.
- Refer to the manufacturer service manual when installation.
- Bolts and nuts may get loosen by engine vibration. Make sure not to loosen any bolts and nuts before driving.
- This instruction sheet is for the instruction for stock condition.

### HOW TO TAKE CARE SCREEN

#### ⚠ ATTENTION

- Under direct sunlight, the deformation, fire, etc trouble might occur because of condensing phenomenon due to concave mirror effect. Be careful when parking.
- In case of parking under direct sunlight, please protect screen from direct sunlight by using soft cloth, etc.
- When windy day, it is easy to get effect by wind, please ride at reduced speed.
- In case of parking with body cover on, please choose shaded and well ventilated place. If park under the high heat with body cover on, temperature increases inside and it might cause of deformation.
- Be careful not to apply battery fluid and brake fluid. It breaks screen.
- Do not apply excessive force and hard bend. It might cause of broken.
- Please check regularly to make sure not to loosen and slip. Please do additional tightening in need.
- Welnut get aging by ultraviolet rays and aging. If deterioration is remarkable, please change to new one.
- If there is a hard scratch and break on screen, please change to new one because it might fall off.
- In case that screen gets dirt, wipe with soft cloth or sponge with lots of water. Do not use blush because screen is easy to get scratch.
- In case of screen gets heavy dirt, please use neutral detergent. Do not use abrasive powder, organic solvent, acid / alkaline detergent, gasoline, benzine, sinner, etc.

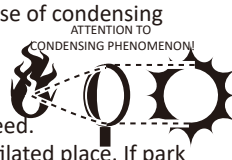

### PACKING LIST

FIGURE	NAME		CODE	QTY
1	VISOR (SCREEN)	CLEAR	670-9000003	× 1
		SMOKE	670-9000103	× 1
2	STAY	L /JOG125	670-0230001	× 1
3	STAY	R /JOG125	670-0230002	× 1
4	PAN HEAD (+) SCREW (B)	M5x20	052-0503020	× 4
5	WASHER (B)	12x5.2xT1.5mm	090-0914005	× 4
6	RUBBER COLLAR	13x6.2xT1mm	0900-094-09801	× 4
7	WELNUT C550L	M5x0.8	678-0500101	× 4

## HOW TO INSTALL

### ※ADVICE

When installing, tighten each bolt temporarily. Then tighten firmly with adjusting balance of left and right.

- 1) Remove genuine mirror.
- 2) Check the direction of mirror adaptor and stay L/R, then install temporarily to mirror installation point. (Refer to the illustration below.)
- 3) Install visor (screen) temporarily with attached welnut/bolt/washer while adjusting balance of left and right.
- 4) After adjusting each parts balance, tighten bolts firmly.

### ATTENTION!

- Basically, reuse genuine parts if it is unattached.
- If there is a hard degradation like a blem, fatigue and wear etc on the reuse parts, please change to new ones.

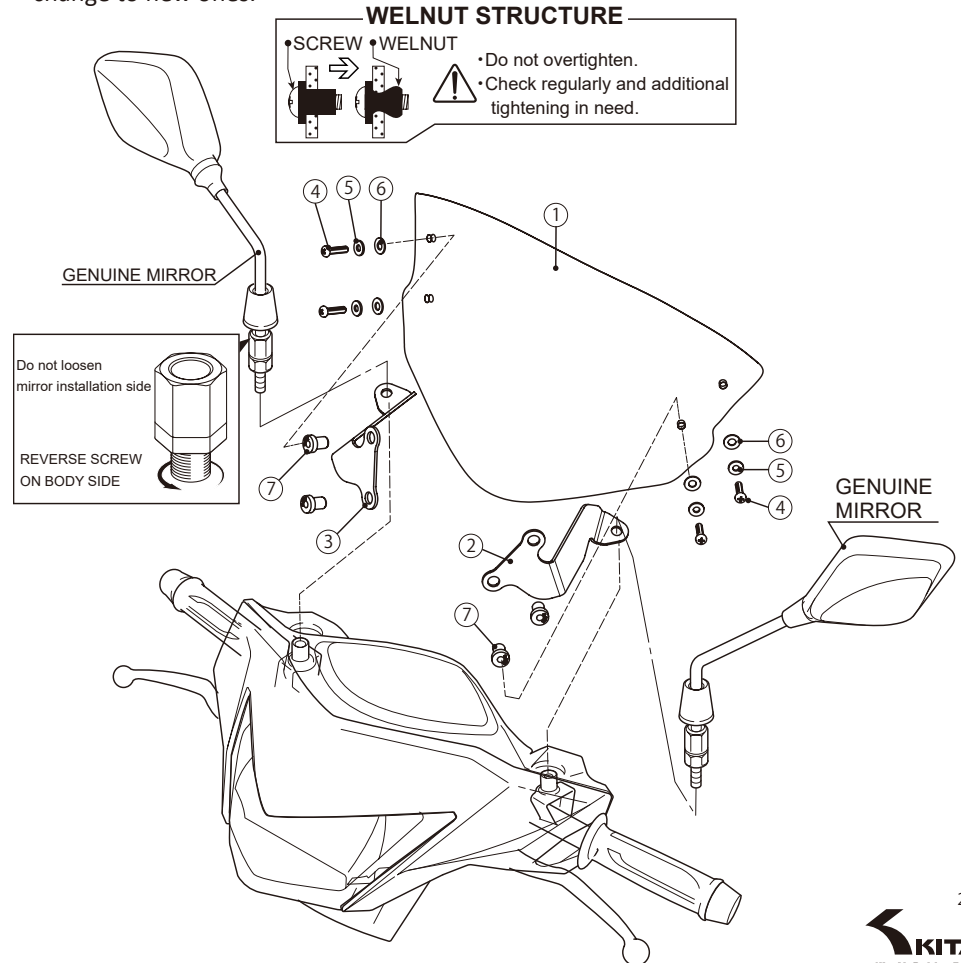

230607 M-T



3-8-13 NAGATA,  
HIGASHI-OSAKA,  
OSAKA, JAPAN