

FENDER LESS KIT type 2 NO.1/2

CODE : 691-1840100

APPLICATION : CBR250RR (MC51)

● Thank you for purchasing Kitaco product. Read and understand the instruction before installing.

ATTENTION (MUST READ)

- This instruction sheet is for the instruction for genuine condition.
- This product is for dress-up parts. Do not use for other purposes.
- This product is designed and made exclusive for application vehicle, do not use other models. Do not modify the way which is not listed or it will cause damage and trouble.
- We are not responsible for violation of law or damages and accidents caused by assembling mistake and improper setting.
- Please ask authorized mechanic for assembling and setting.
- Refer to the manufacturer service manual when installation.
- Bolts and nuts may get loosen by engine vibration. Make sure not to loosen any bolts and nuts before driving.

PACKING LIST (Refer to the figure & illustration on right side.)				
FIGURE	NAME		CODE	QTY
1	BASE STAY	(T-2) CBR250RR	691-1840101	1
2	SIDE STAY L	(T-2) CBR250RR	691-1840103	1
3	SIDE STAY R	(T-2) CBR250RR	691-1840104	1
4	LICENSE NUMBER STAY	(T-2) CBR250RR	691-1840102	1
5	WINKER SPACER	CBR250RR	691-1840002	2
6	SPACER COLLAR	6.2x10xL17.4mm	691-1840008	2
7	SPACER COLLAR	6.2x10xL4.2mm	691-1840009	2
8	BUTTON CAP BOLT BLACK	M4x15	040-0551015	2
9	BUTTON CAP BOLT BLACK	M6x15	060-0551015	4
10	CAP BOLT	M6x22	060-0500022	2
11	CAP BOLT	M6x35	060-0500035	2
12	FLAT HEAD CAP BOLT	M6x15	063-0600015	4
13	WASHER	6x13x1.0	090-0900006	12
14	SPRING WASHER	6mm	091-0500006	12
15	NUT	6mm	001-0500006	12
16	WASHER	4x8x0.8	090-0903004	2
17	SPRING WASHER	4mm	091-0500004	2
18	NUT	4mm	001-0500004	2
19	HARNESS CLIP	6mm	751-9000002	4

OPTION PARTS				
FIGURE	NAME		CODE	QTY
OP	REFLECTOR KIT (For 126cc~)		801-0800300	1

REAR COWL INSTALLING / REMOVING ILLUSTRATION

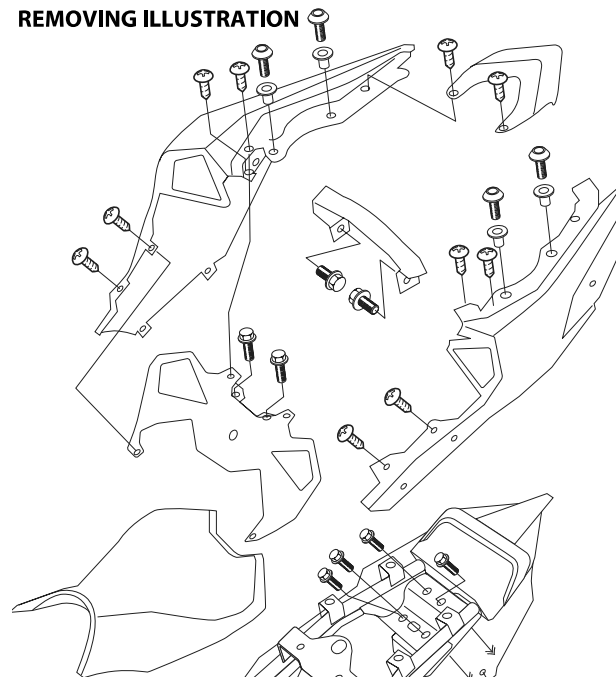

■HOW TO INSTALL

(This illustration is just a reference. Please refer to the manufacturer service manual.)

- 1) Remove front / rear seat, side cover, rear cowl and rear fender A (bracket). (Remove other parts to ease installation.)
- ※ Be careful not to break cowl nails when installing / removing.
 - ※ Remove connection of winker and license lamp.
- (Continue to other paper no.2)

REAR FENDER A DEVELOPMENT ILLUSTRATION

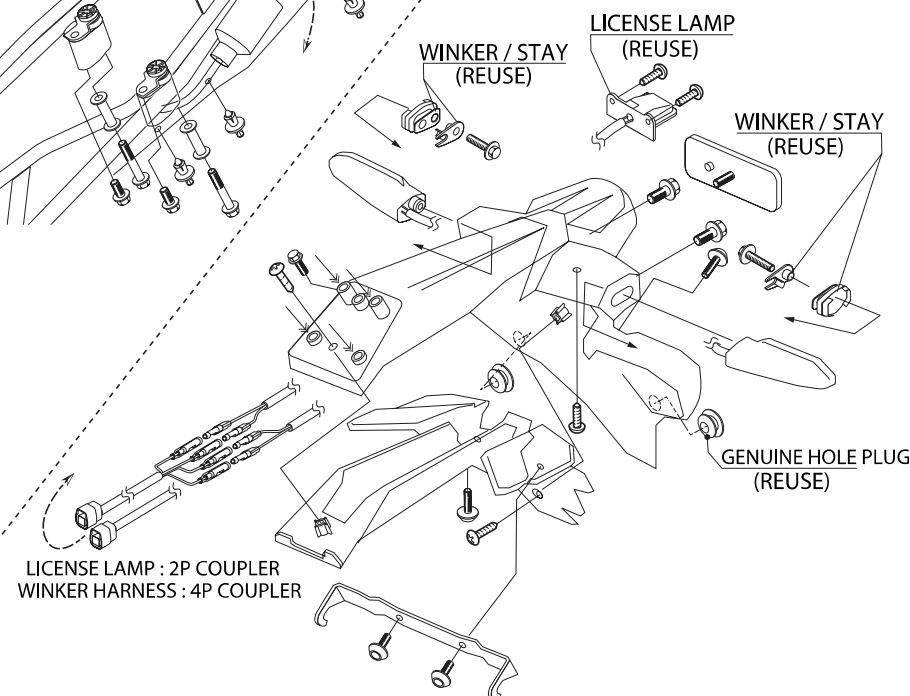

FENDER LESS KIT type 2 NO.2/2

CODE : 691-1840100

APPLICATION : CBR250RR (MC51)

■ **HOW TO INSTALL** (Illustration is just a reference, please refer to the manufacturer service manual.)

2) Install attached fender less parts. (Refer to the illustration.) Reuse genuine winker and license lamp.

※After rerouting and wiring each wire, please tie extra wire to frame, etc with attached harness clamp not to hang down.

3) Tighten temporarily tightened bolts. Make sure not to loosen any parts and all lamps work correctly before riding.

ATTENTION!

★Because of vehicle structure, water or dirt insert from harness through hole splashed by rear tire. Recommend to water proof treatment by sponge, rubber, etc.

PACKING LIST (SAME AS No.1 sheet.)

FIGURE	NAME	CODE	QTY
1	BASE STAY (T-2) CBR250RR	691-1840101	1
2	SIDE STAY L (T-2) CBR250RR	691-1840103	1
3	SIDE STAY R (T-2) CBR250RR	691-1840104	1
4	LICENSE NUMBER STAY (T-2) CBR250RR	691-1840102	1
5	WINKER SPACER CBR250RR	691-1840002	2
6	SPACER COLLAR 6.2x10xL17.4mm	691-1840008	2
7	SPACER COLLAR 6.2x10xL4.2mm	691-1840009	2
8	BUTTON CAP BOLT BLACK M4x15	040-0551015	2
9	BUTTON CAP BOLT BLACK M6x15	060-0551015	4
10	CAP BOLT M6x22	060-0500022	2
11	CAP BOLT M6x35	060-0500035	2
12	FLAT HEAD CAP BOLT M6x15	063-0600015	4
13	WASHER 6x13x1.0	090-0900006	12
14	SPRING WASHER 6mm	091-0500006	12
15	NUT 6mm	001-0500006	12
16	WASHER 4x8x0.8	090-0903004	2
17	SPRING WASHER 4mm	091-0500004	2
18	NUT 4mm	001-0500004	2
19	HARNESS CLIP 6mm	751-9000002	4

OPTION PARTS

FIGURE	NAME	CODE	QTY
OP	REFLECTOR KIT (For 126cc~)	801-0800300	1

※Basically, reuse genuine parts if it is not attached.

※If there is a hard degradation like a blem, fatigue and wear etc on the reuse parts, please change to new ones.

