

SPEED PULSE CONVERT UNIT & SENSOR (FOR 5 SPEED TRANSMISSION) No.1 / 2		
CODE	GROM : 752-1432900	MONKEY 125 : 752-1300900
APPLICATION	GROM (JC61) 5 SPEED TRANSMISSION TYPE	MONKEY 125 (JB02) 5 SPEED TRANSMISSION TYPE ※ Non-usable for ABS model.
REMARK	※Recommend to use genuine disc rotor bolt. (Sensor might not work with non-genuine disc rotor bolt because of bolt head output. In that case, it needs to replace the position, or change the bolt.) ※This product might not work with non-genuine meter.	

- Thank you for purchasing Kitaco product. Read and understand the instruction before installing.
- ※ The spare parts do not include the instruction sheet, please keep this safe.

### ATTENTION (MUST READ)

- We are not responsible for violation of law or damages and accidents caused by assembling mistake and improper setting.
- Please ask authorized mechanic for assembling and setting.
- Do not modify the way which is not listed or it will cause damage and trouble. Do not give a strong shock and disassemble.
- Refer to the manufacturer service manual when installation.

SPEC	ATTENTION (MUST READ)
In case of genuine 4 speed transmission, read gear speed by sensor in crank case. However, in case of 5 speed transmission, the gear shape, etc is changed, therefore genuine sensor cannot read gear speed. This product read speed from front wheel disc rotor bolt, then convert pulse for genuine meter. Also, this product has "tire O.D. setting" and "point number setting" to compatible with changing tire sizes and the numbers of disc rotor bolts.	<p>▼INSTALLATION AND USING</p> <ul style="list-style-type: none"> <li>● We are not responsible for the installation of special electrical customized vehicle. (HID, audio products, etc)</li> <li>● This kit is not completely waterproof. Place it where it does not get wet or rain.</li> <li>● For wiring process, please follow instruction and wiring illustration.</li> <li>● This product is precision equipment. If installed to a lot of vibration place, it causes inability to perform as intended and at the worst case, it might break. If mounted beside of engine, it might malfunction by heat and vibration. ※ Malfunction by heat and vibration is out of warranty. Be careful of it.</li> <li>● Do not install near the IG coil, high tension code, etc, it might cause of trouble.</li> <li>● Do not disassemble. It might cause of trouble and break.</li> </ul>

PACKING LIST			GROM	MONKEY
FIGURE	CODE	NAME	QTY	QTY
1	752-1432901	SPEED SENSOR	1	1
2	752-1432909	SPEED SENSOR STAY GROM	1	-
	752-1300902	SPEED SENSOR STAY MONKEY 125	-	1
3	062-0561015	FLANGE BOLT M6x15	1	1
4	001-0550006	FLANGE LOCK NUT M6	1	1
5	752-1432908	FLANGE BOLT M8x28	1	1
6	762-1432900	PULSE UNIT	1	1
7	755-0919083	CONVERT HARNESS	1	1
8	700-9200100	TIE WRAP	2	4

### INSTALL

- ※ For installing this product, removing/installing outer cowls is required. Refer to the genuine service manual when installation.
- ※ Please remove the battery to connect wire. It might cause of accident.

- 1 Remove shroud and head light to route speed sensor wire through.
- 2 Install attached temporarily condition speed sensor. (Refer to the speed sensor installation on the right side.)
- 3 Connect speed sensor (3P coupler white/red wire) inside connector boots to insert speed convert harness.
- 4 Referring to the instruction No.2, do the speed sensor unit (tire O.D. / rev) setting.

### 2. HOW TO INSTALL SPEED SENSOR

- With speed sensor & stay temporarily tightened, tighten them with attached flange bolt (5)M8x28 under genuine caliper installation bolt.
- After installation, rotate front wheel to make sure not to interference sensor and disc rotor.
- ※ Recommend to use genuine disc rotor bolt. (Sensor might not work with non-genuine disc rotor bolt because of bolt head output. In that case, it needs to replace the position, or change the bolt.)
- Route speed sensor harness tightened with caliper along the main harness, etc.
- ※ When handling, be careful not to have harness caught in.

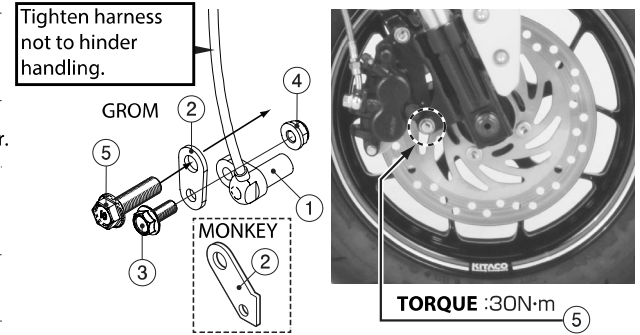

Depending on type and head output of disc rotor, it might need to change sensor position.

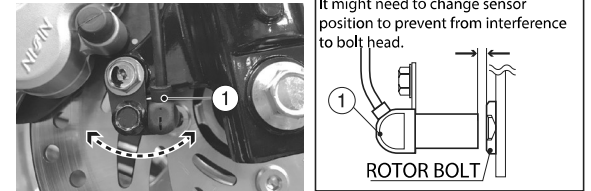

### 3. VEHICLE SIDE HARNESS ILLUSTRATION (SPEED SENSOR / CONNECTOR POSITION)

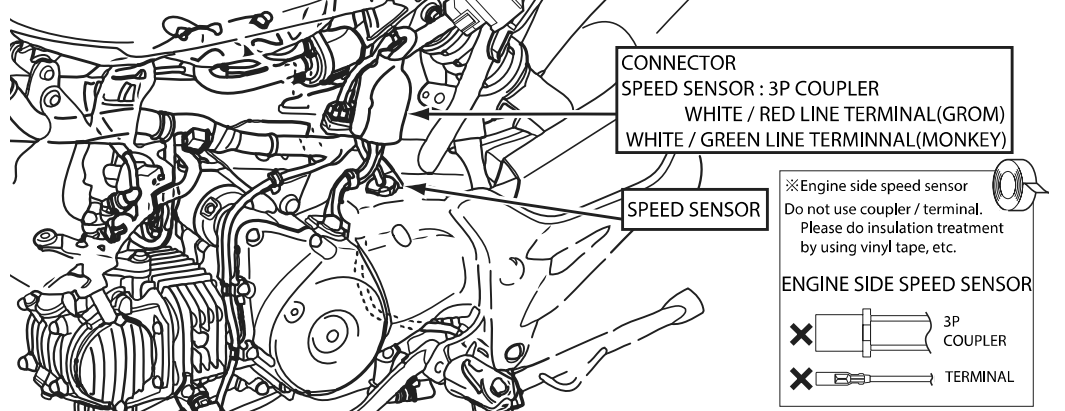

### ● WIRING ILLUSTRATION (Refer to the No.2 harness illustration.)

※ Must to waterproof treatment to wiring and coupler point by roll vinyl tape, etc.

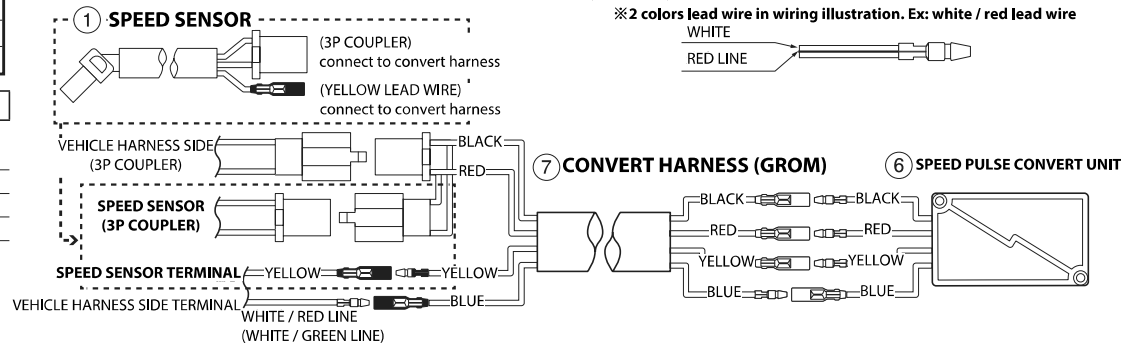

SPEED PULSE CONVERT UNIT & SENSOR (FOR 5 SPEED TRANSMISSION) No.2/2		
CODE	GROM : 752-1432900	MONKEY 125 : 752-1300900
APPLICATION	GROM (JC61) 5 SPEED TRANSMISSION TYPE	MONKEY 125 (JB02) 5 SPEED TRANSMISSION TYPE ※ Non-usable for ABS model.
REMARK	※ Recommend to use genuine disc rotor bolt. (It might not work sensor with non-genuine disc rotor bolt because of bolt head output. In that case, it needs to replace the position, or change the bolt.) ※ This product might not work with non-genuine meter.	

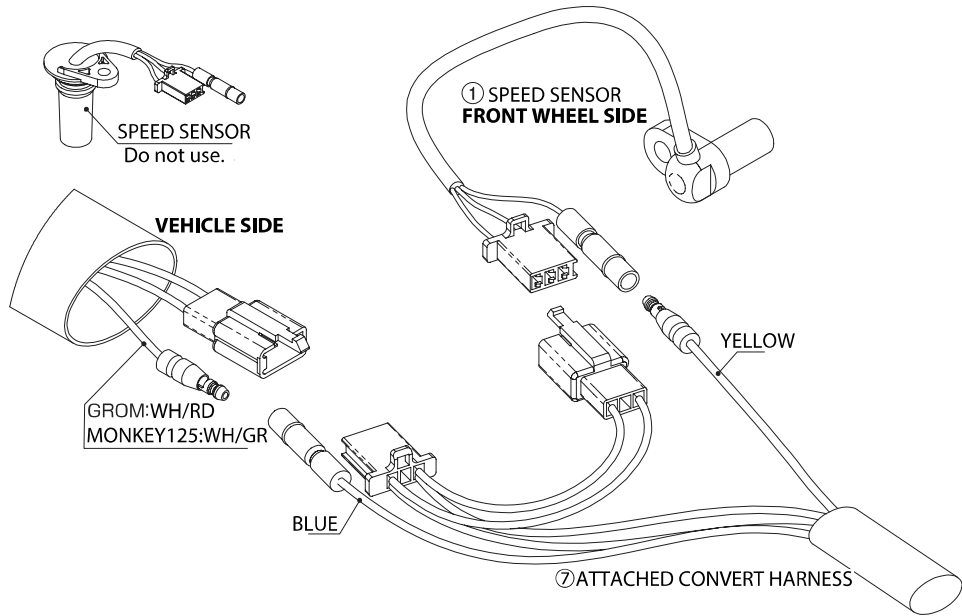

## HOW TO SET UP AND USE

1 Input the tire O.D. / rev revise number to pulse convert unit main unit. When setting, there is a counter and switch (push button) inside the main unit, please remove lid (with 2 screws).

※ [Default setting is [tire O.D.(mm)=1500] [Disc rotor bolt point number = 4] .]

2 Turn ignition on while pushing push button switch. After 7seg. LED is lit, leave the push button switch. It turns to setting mode, so please set up revise value of front / rear sprocket and tire sizes referring to the diagram. [Refer to the setting diagram.]

3 Finish setting mode. Display the [F]→[R]→[r] in this order, then turn the ignition off after turning back to [F].

※ Getting back to [F] to save the setting.

Make sure not to loosen any parts before riding. Please do a test ride to check the meter display correctly.

※ Do not set up on public road. Riding with wrong setting may cause of road traffic law violation.

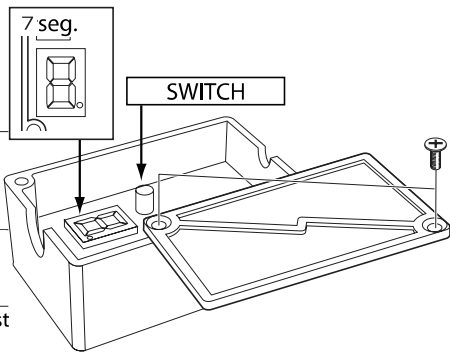

## ● TIRE O.D. / POINT (ROTATE) DIAGRAM

### HOW TO START

#### STEP1

Turn ignition key to ON while pushing button.

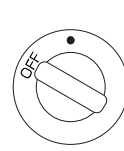

#### STEP2

Turn the key to ON while pushing button.

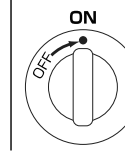

#### STEP3

After 7seg. LED (shows F) is lit, leave the button.

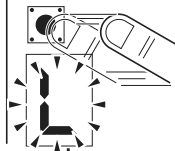

ATTENTION!  
(If display shows other than "F", turn ignition key OFF, then continue the process from beginning to show "F" again.)

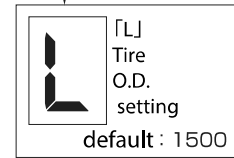

Push button  
each time

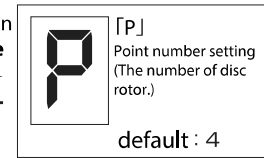

↓ Hold the button down.

↓ Hold the button down.

### TIRE O.D. REVISE SETTING

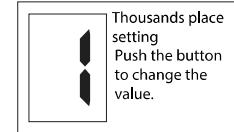

↓ Hold the button down. (confirm)

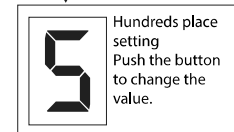

↓ Hold the button down. (confirm)

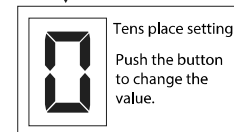

↓ Hold the button down. (confirm)

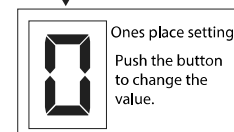

↓ Hold the button down. (confirm)

※ Push the button to show "L" to save setting.

### POINT NUMBER SETTING

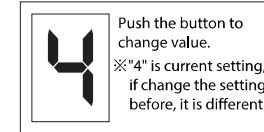

↓ Hold the button down. (confirm)

※ Display "L" means save each setting.

↓ Turn off while showing "L". (Key OFF)

Finish setting.

↓ To point number setting.

230113 M-T