

SPEED PULSE CONVERT UNIT & SENSOR (FOR Z125 PRO 5SP TRANSMISSION) No.1/2

CODE : 752-4030900

APPLICATION : Z125 PRO (BR125H) WITH 5SP TRANSMISSION

※With aftermarket disc rotor bolts which might have different head shape, sensor might not activate correctly. That case, you might require to adjust the bolts position or exchange.

- Thank you for purchasing Kitaco product. Read and understand the instruction before installing.
- Please keep the instruction for later needs.

ATTENTIONS (MUST READ)

- We are not responsible for damages and accidents caused by assembling mistake and improper setting.
 - Please ask authorized mechanic for assembling and setting.
- Ask a specialist at specialty shop if you do not understand the role of the surrounding parts.
- Do not modify the way which is not listed or it will cause damage and trouble.
 - Refer to the manufacturer HONDA service manual when installation.
 - Please contact a mechanic nearby immediately when you find something unusual.

FEATURE	This product reads revolution from rear sprocket bolts and converts the pulse for stock speedometer. Also, it can be usable for vehicles with tyre size change as well as rotor bolt number change.
ATTENTION (MUST READ)	▼ ATTENTION
	● This product might not work correctly with some specific electrical parts such as (HID / acoustic parts and so on)
	● This product is not perfect waterproof. Try not to get wet as much as possible. Keep your vehicle at the place where it does not get rainy.
	● Follow the instruction of wiring mods as specified in it.
	● Keep this product at the place without much vibration, to avoid breakage. This product might not activate correctly when mounted close to the motor due to heat & vibration.
	※ Any failure due to heat or vibration is out of warranty
	● Do not place wirings close to ignition coil / high tension code.
	● Disassembling this product is not allowed, to avoid malfunction and breakage.

PACKING LIST			
FIG	CODE	NAME	QTY
1	752-1432901	SPEED SENSOR	1
2	752-4030901	SPEED SENSOR STAY	1
3	060-0550015	FLANGE BOLT M6 × 15	1
4	001-0550006	FLANGE LOCK NUT M6	1
5	752-4030900	PULSE CONVERT UNIT (Z125/REAR)	1
6	755-4030902	CONVERT HARNESS	1
7	0900-751-09002	HARNESS CLIP	1
8	700-0500100	TIE WRAP	2

HOW TO INSTALL

- ※ REFER TO HONDA SERVICE MANUAL TOGETHER WITH THIS INSTRUCTION AS REMOVING OUTSIDE PLASTICS IS REQUIRED
 - ※ MAKE SURE TO REMOVE BATTERY BEFORE CONNECTION TO AVOID UNEXPECTED ACCIDENT
- 1 Remove speed sensor (3P coupler) out of L crankcase, install dummy coupler in the kit.
 - 2 Install speed sensor in the kit temporarily.
(Refer to speed sensor installation)
 - 3 Insert convert harness from speed sensor harness.
(Refer to WIRING)
 - 4 Set up speed sensor unit (tyre outer circumference / revolution number) on page 2.

INSTALLING SPEED SENSOR

- Install speed sensor / speed sensor stay temporarily.
- Tighten them together with harness clamp with OEM chain gear (R fender) installing bolt (M6 x 12).
- After installation, move the front wheel to see if sensor interferes with disc rotor bolts or not and so on.
- ※ With aftermarket disc rotor bolts which might have different head shape, sensor might not activate correctly. That case, you might require to adjust the bolts position or exchange with different bolts.
- Reroute speed sensor harness along frame with harness clip / tie-wrap.
- ※ Be careful to route harness not to interfere steering.

WIRING

- ※ Make sure to waterproof finish with vinyl tape and so on.

※2-color lead wire
ex. WHITE / RED LEAD WIRE

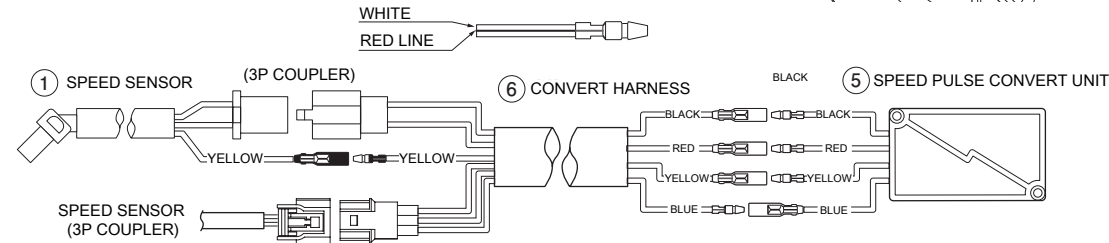

ENGINE (CRANK CASE) SIDE
SPEED SENSOR
(3P COUPLER)

DUMMY COUPLER
(3P COUPLER)

SPEED SENSOR
CONNECTOR : 3P COUPLER

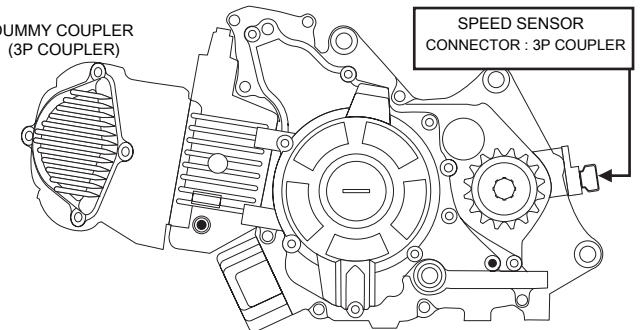
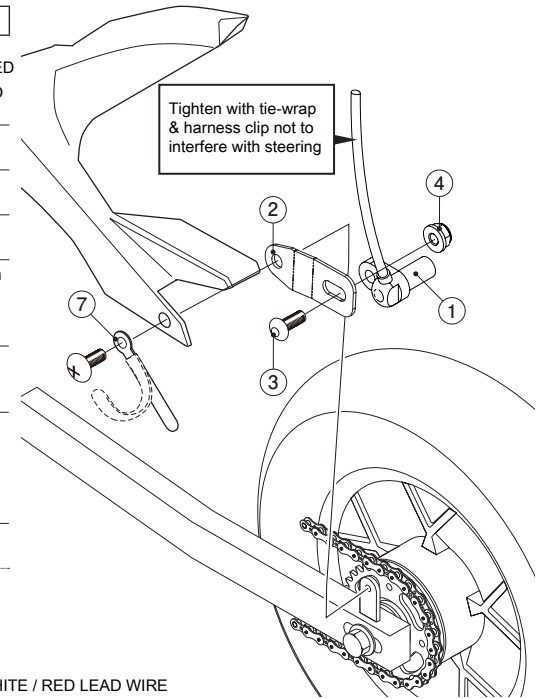

SPEED PULSE CONVERT UNIT & SENSOR (FOR Z125 PRO 5SP TRANSMISSION) No.2/2

CODE : 752-4030900

APPLICATION : Z125 PRO (BR125H) WITH 5SP TRANSMISSION

※With aftermarket disc rotor bolts which might have different head shape, sensor might not activate correctly.
That case, you might require to adjust the bolts position or exchange.

HOW TO SET UP / OPERATE

- 1 Input tyre outer circumference / point number on convert unit.
There are display & switch.
Remove 2 screws and lid.

※ "Tyre outer circumference (mm) = 1500" & "detection number = 4" are in default.
Refer to right side chart

- 2 With holding the switch inside, turn on the ignition for tyre outer circumference / point number setting mode. [Refer to right side chart]

- 3 Finishing setting mode
Set up "L" & "P", then after displaying "L", turn off the ignition.

※ Save the each setup data when goes back to "L" again.

Make sure that the parts are installed correctly before actual run for test.

※ Do not setup in the public street.
Driving without correct setting is against laws or regulations in most of the countries.

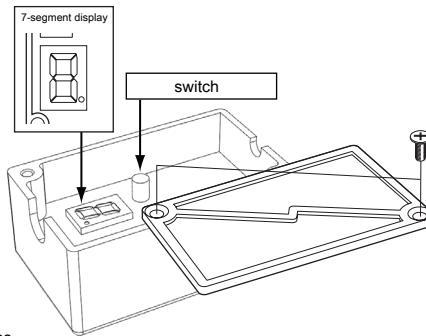

● TYRE OUTER CIRCUMFERENCE / POINT NUMBER SETTING CHART

HOW TO START

- STEP1** With holding the switch inside, turn on the ignition.
- STEP2** Holding the button, turn on the ignition.
- STEP3** Release the finger after "L" is displayed.

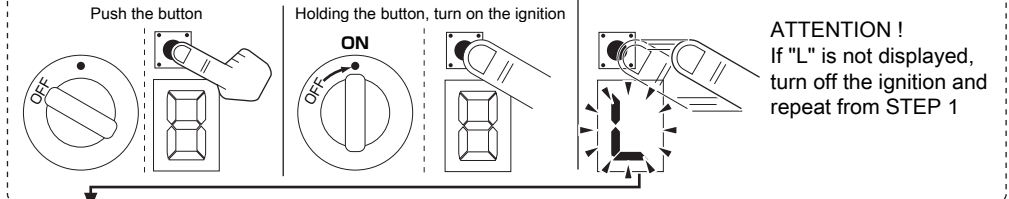

ATTENTION !
If "L" is not displayed,
turn off the ignition and
repeat from STEP 1

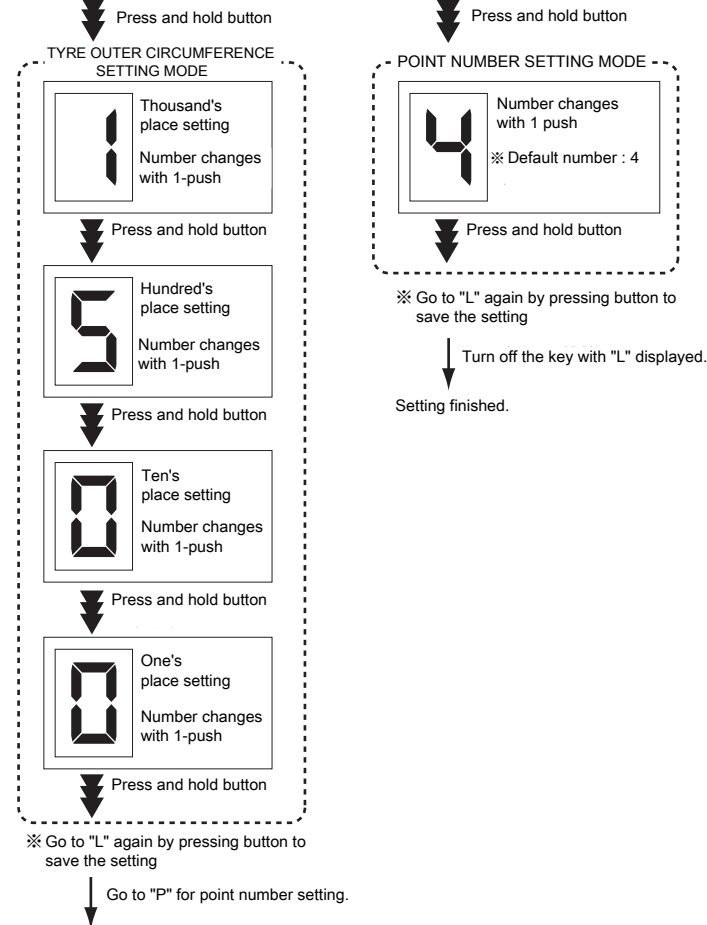
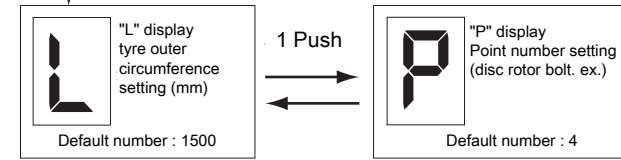

170508

3-8-13 NAGATA
HIGASHI-OSAKA,
OSAKA. 577-0015.



株式会社 豊工具 JAPAN