

# HANDLE SWITCH (L)

CODE : 756-1470100

APPLICATION : HUNTER CUB CT125 (JA55)

● Thank you for purchasing Kitaco product. Read and understand the instruction before installing.

## ATTENTION (MUST READ)

- This product is designed and made exclusive for application vehicle, do not use other models. Do not modify the way which is not listed or it will cause damage and trouble.
- We are not responsible for violation of law or damages and accidents caused by assembling mistake and improper setting.
- Please ask authorized mechanic for assembling and setting.
- When installation, must turn main switch OFF, and headlight is completely cool. It might cause of electric shock and burn.
- Bolts and nuts may get loosen by engine vibration. Make sure not to loosen any bolts and nuts before driving.
- This instruction sheet is for the instruction for genuine condition.

PACKING LIST				
FIGURE	NAME	CODE	QTY	
-	HANDLE SWITCH ASSY	CT125 (JA55)	756-1470101	x1
-	SCREW WASHER	M5x16	052-0042016	x2
-	LED WINKER RELAY	(3P) 12v100w	755-0400940	x1
-	POSITION MATCHING PATTERN PAPER (on this sheet)	CT125	-	x1

## HOW TO INSTALL

- 1) Remove side left (L) handle switch connector under meter, then remove L handle switch. (Refer to the wiring illustration.) Remove L side bar end (inner weight) from handle. (Refer to the bar end install/remove illustration)
  - 2) Make a new hole for installation by using attached pattern paper. (Refer to the illustration 2)
  - 3) Wire Kitaco handle switch harness in the same way as genuine.
  - 4) Install with attached bolt while the new hole and handle switch pin is matched. (Refer to the illustration 4)
- ※ Need to use attached screw M5x16 because the genuine (M5x20) one length is different, it cause of break.  
 ※ Tighten screw from upper side to lower side. (TORQUE:2.5N·m)
- 5) Change the genuine winker relay to attached Kitaco winker relay.
  - 6) Put back the removed parts. Make sure the switch works correctly.

### Making new hole

- 2) Cut the instruction sheet pattern paper, then roll to handle pipe. Match the genuine hole position as illustration below to decide where to make it.

- 4) ※Using attached screw M5x16 is required. Genuine one (M5x20) length is different, it cause of break.  
 ※Tighten from upper side screw and lower side. (TORQUE:2.5N·m)

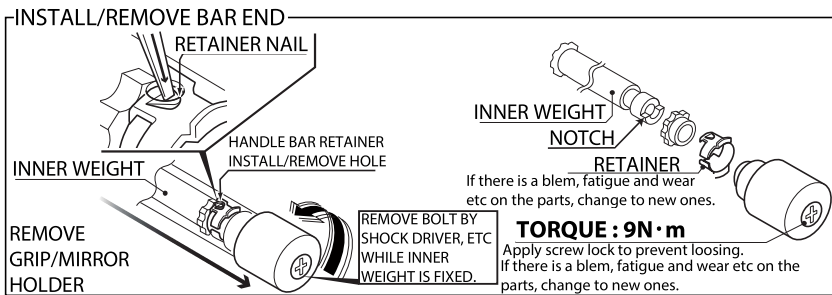
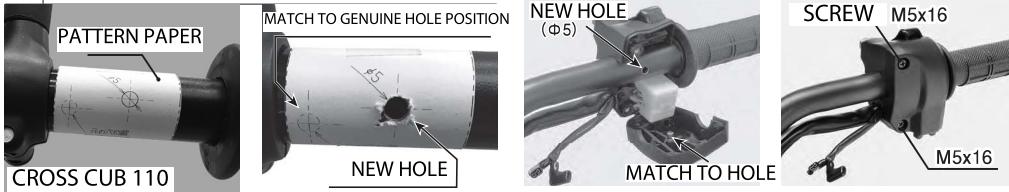

## WIRING ILLUSTRATION

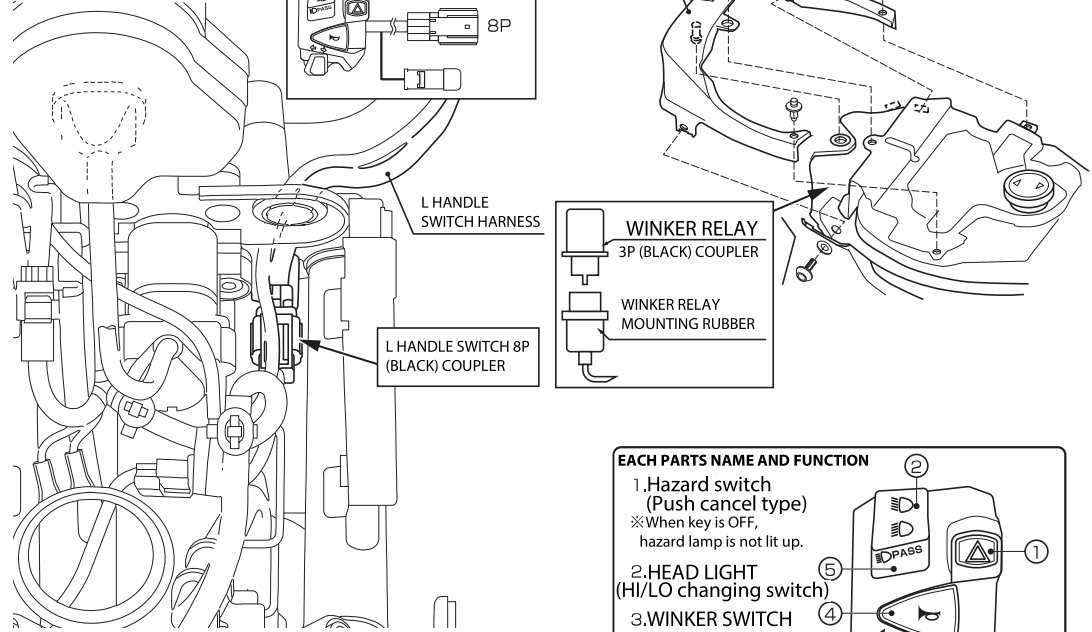

**ABOUT WINKER RELAY**  
 Compare to genuine, flashing may be different, but it is not anomaly.

**EACH PARTS NAME AND FUNCTION**

1. Hazard switch (Push cancel type)  
 ※When key is OFF, hazard lamp is not lit up.
2. HEAD LIGHT (HI/LO changing switch)
3. WINKER SWITCH (PUSH CANCEL TYPE)
4. HORN SWITCH
5. PASSING SWITCH

## IMPORTANT! Pattern paper print setting.

When printing pattern paper, please select "actual size" by print setting option. Except the "actual size", the pattern paper prints smaller than actual, it might make hole out of instruction and cannot fix it. Be careful of it. We are not responsible for processing error. Please understand before printing.

Soft ware : Adobe Acrobat Reader DC

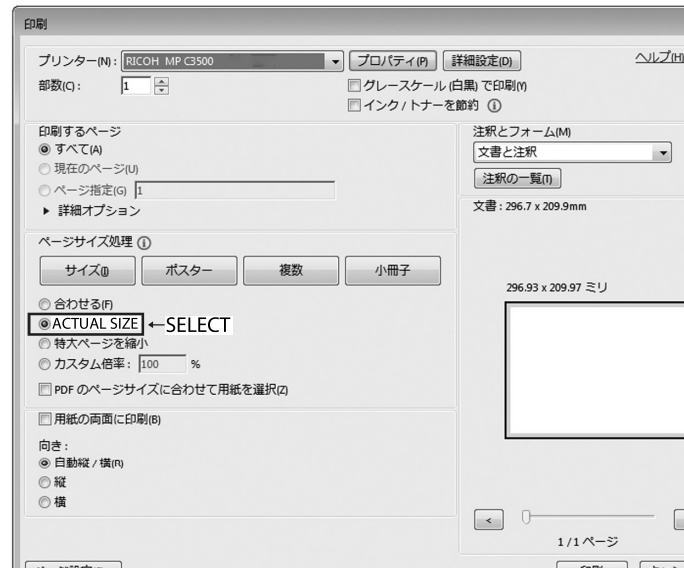

## NEW HOLE PATTERN PAPER

