



REAR CARRIER	
CODE	(BLACK) 80-539-13200 -
APPLICATION	DAX 125 (JB04)
REMARK	

Thank you for purchasing Kitaco product. Read and understand the instruction before installing.

ATTENTIONS (MUST READ)

- This instruction sheet is for the genuine condition. Refer to the service manual when installation.
- Do not apply excessive force to carrier and back rest. It might break this product or surrounding parts.
- This product is designed and made exclusive for application vehicles, do not use other models. Do not modify the way which is not listed or it will cause damage and trouble.
- We are not responsible for violation of law or damages and accidents caused by assembling mistake and improper setting.
- Please ask authorized mechanic for assembling and setting.
- Bolts and nuts may get loosen by engine vibration. Make sure not to loosen any bolts and nuts before driving.

 Do not apply excessive force to carrier when you use rope or tie to deliver the vehicle. It might damage the rear carrier or surrounding parts.

 Do not overweight on carrier. It might damage the carrier. **(Weight limit : 5.0kg)**

 Do not apply excessive force like lift the vehicle using carrier or grab bar. When you turning the vehicle, use it to helping tool.

HOW TO INSTALL

- 1) Loosen each left and right side rear shock mounting nut and muffler adaptor nut, then remove genuine grab bar.
 - 2) Install Kitaco rear carrier and genuine grab bar to the right place. (Refer to the illustration on the right side.)
 - 3) When installation, tighten temporarily tightened bolts firmly. Make sure not to loosen any parts before riding.
- ※ **TIGHTEN BOLTS ALTERNATELY EVENLY.** tighten only one place may cause of fail installation.

HOW TO TAKE CARE

Rust might occur depending on how to use. Especially, after riding under the rain or washing, wipe water completely, then apply anti-rust, etc.

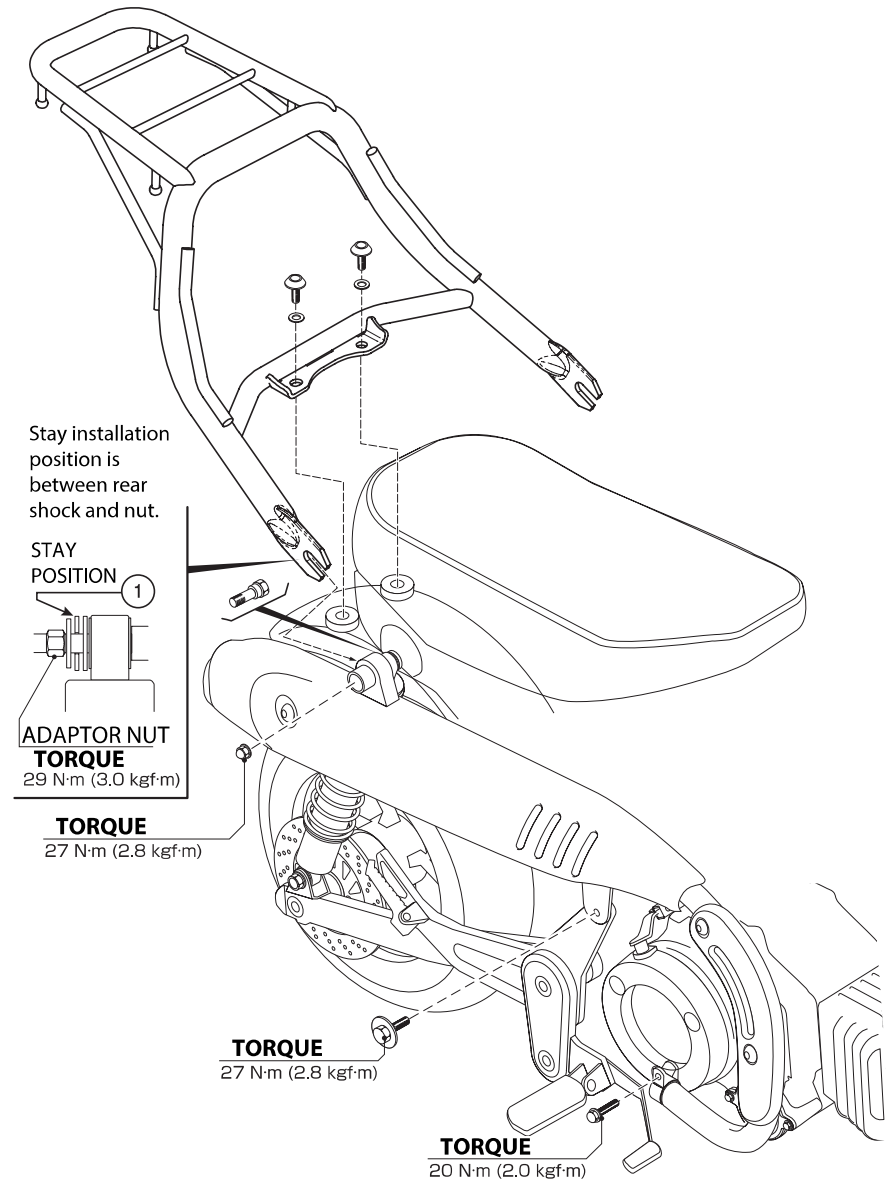

221202 Y-H



〒 577-0015
3-8-13

NAGATA, HIGASHI-
OSAKA, OSAKA,
JAPAN