



HELMET HOLDER



CODE	APPLICATION
80-564-13200	DAX125 (JB04)

Thank you for purchasing Kitaco product.
Read and understand the instruction before installing.

ATTENTION (MUST READ)

- This product is easily attach helmet to motorcycle. It is not theft prevention parts.
 - This product is designed and made exclusive for application vehicle, do not use other models.
 - We are not responsible for violation of law or damages and accidents caused by assembling mistake and improper setting.
 - Refer to the manufacturer service manual when installation.
 - Bolts and nuts may get loosen by engine vibration. Make sure not to loosen any bolts and nuts before driving.
- ※Metal/resin/alumite products get discolored/rust for ages as well as how to use. Please understand when using.

ATTENTION	
	Hanging helmet or something while riding may cause of accident. Do not use when riding.
	Recommend to use our LOCK OIL (880-9900000) for maintenance. Do not use anti-dusting agent, or it causes key trouble.

ATTENTION	
	We do not make a duplicate of key. Please keep keys in safe place.
	Falling off the luggage, breaking hook caused by over weight is not our responsibility.
	Depending on how to use, it may cause scratches. Do not use when riding.

PARTS

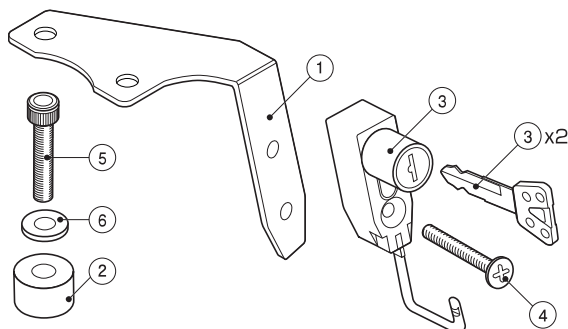

PACKING LIST			
FIGURE	NAME	CODE	QTY
1	HELMET HOLDER STAY	564-1320001	x1
2	SPACER COLLAR 8.2x18xT15	093-9000053	x2
3	HELMET LOCK (T-2) BLACK	503-0600100	x1
4	COUNTERSUNK SCREW M6x30	063-0511030	x1
5	CAP BOLT M8x40	060-0500040	x2
6	WASHER 8x16xT1.2mm	090-0900008	x2
OPTIONAL PARTS			
-	LOCK OIL	880-9900000	1

HOW TO INSTALL

1. Remove genuine parts.

1) Remove genuine grab bar socket bolt (2pcs). [Illustration I]

2. Install helmet holder stay temporarily.

1) Install with attached bolts to genuine grab bar socket bolt (2pcs) positions temporarily. [Illustration II]

3. Fix each parts.

1) After adjusting balance, tighten each bolts firmly.

※Follow the tightening torque to tighten bolts.

4. Install helmet holder assy to stay.

1) Do final tightening each bolts.

※Tighten bolts with specified torque.

(Illustration I)

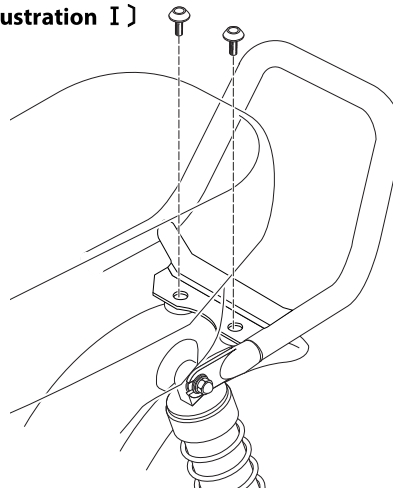

(Illustration II)

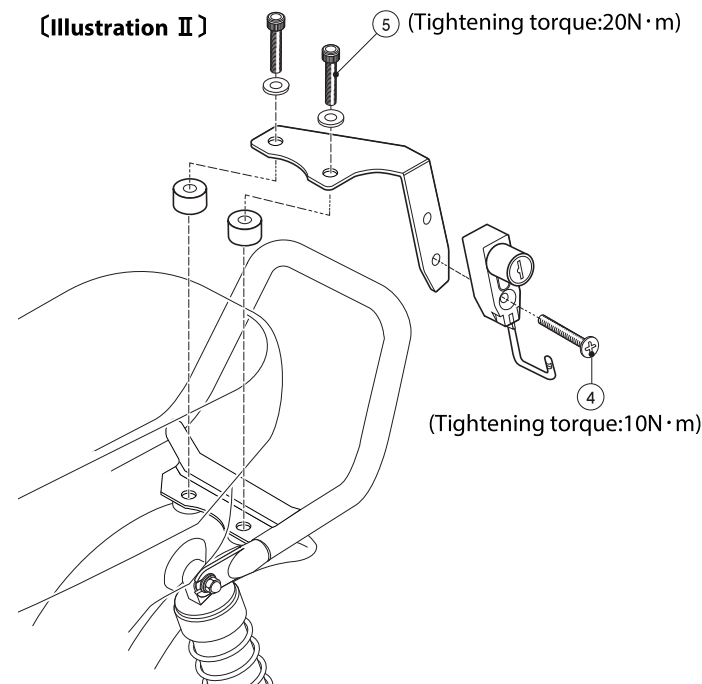

INSPECTION AFTER INSTALLATION

※Installed bolts get loosen by vibration or shock while riding.

After 500km riding or doing inspection regularly to make sure all bolts are tighten firmly. Additional tightening with standard torque.)

製造元

 〒 577-0015
3-8-13 NAGATA, HIGASHI-
OSAKA, OSAKA, JAPAN
株式会社キタコ