

FRONT FASHION BAR for 8mm mirror hole		
CODE	SILVER : 80-617-14240	BLACK : 80-617-14241
APPLICATION	For 8mm mirror hole [LITTLE CUB (C50-4300001~ / AA01) / SUPER CUB110 (JA07), etc]	
PURPOSE	Stay with bar that is compatible with $\Phi 22.2$ handle clamp, commercial mobile holder, etc. (Each holders are not attached.)	

•Thank you for purchasing Kitaco product. Read and understand the instruction before installing.

#### ATTENTION (MUST READ)

- This instruction sheet is for the instruction for stock condition.
- This product is designed and made exclusive for  $\Phi 22.2$  handle clamp., do not use other models. Do not modify the way which is not listed or it will cause damage and trouble.
- This product is tightend with mirror together. This might not to be installed according to commercial holder or vehicle model.
- We are not responsible for violation of law or damages and accidents caused by assembling mistake and improper setting.
- Please ask authorized mechanic for assembling and setting. Ask a specialist at specialty shop if you do not understand the role of the surrounding parts.
- Refer to the manufacturer service manual when installation.

#### ⚠ ATTENTION (MUST READ)

- When installing this product, other mirror adopter might be required.
- In case of installing this product to handle, do not apply excessive force to prevent handling. It might cause of break or accident. [WEIGHT LIMIT : 500g]
- When installing commercial holder, install it firmly. We recommend to prevent from falling with strap, band, etc. We do not take responsibility for the product that installed.
- Please ride under the legal speed. This product is designed for paved roads. Do not use for competition or bad road riding.
- Do not gaze or use the mobile phone, adjust degree while riding.
- Do not use, keep or leave mobile phone under the direct sunlight. It might cause of machine break. Please follow the machine instruction.

#### DIMENSION DRAWING

\*Dimensions is approximate value.

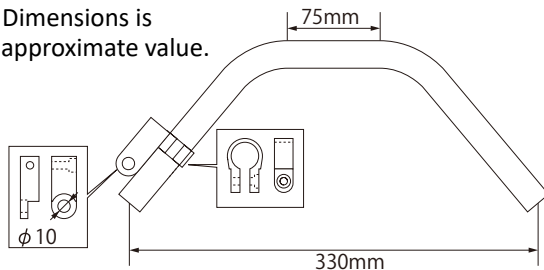

#### PACKING LIST

FIGURE	NAME	CODE	QTY
1	HANDLE CLAMP STAY 8mm	SILVER	539-0900100
		BLACK	539-0900120
2	HANDLE CLAMP STAY 8mm	SILVER	539-0900110
		BLACK	539-0900130
3	FASHION BAR $\Phi 22.2$	539-1157661	× 1
	END CAP	998-0900005	× 2
4	CAP BOLT M6 x 35	060-0510035	× 2
5	FASHION BAR CLAMP	619-0801980	× 2

#### ATTENTION!

- \*Install this product temporarily first, then tighten alternately evenly.
- \*The difference from both left and right mirror hole (brake lever) installation degree, it might not be able to install equally on both sides.
- \*Make sure not to break any parts and loosen each bolts regularly.

#### LITTLE CUB50 / SUPER CUB110 (JA07) RIGHT SIDE INSTALLATION ILLUSTRATION (INSTALL AS SAME AS ON THE LEFT SIDE)

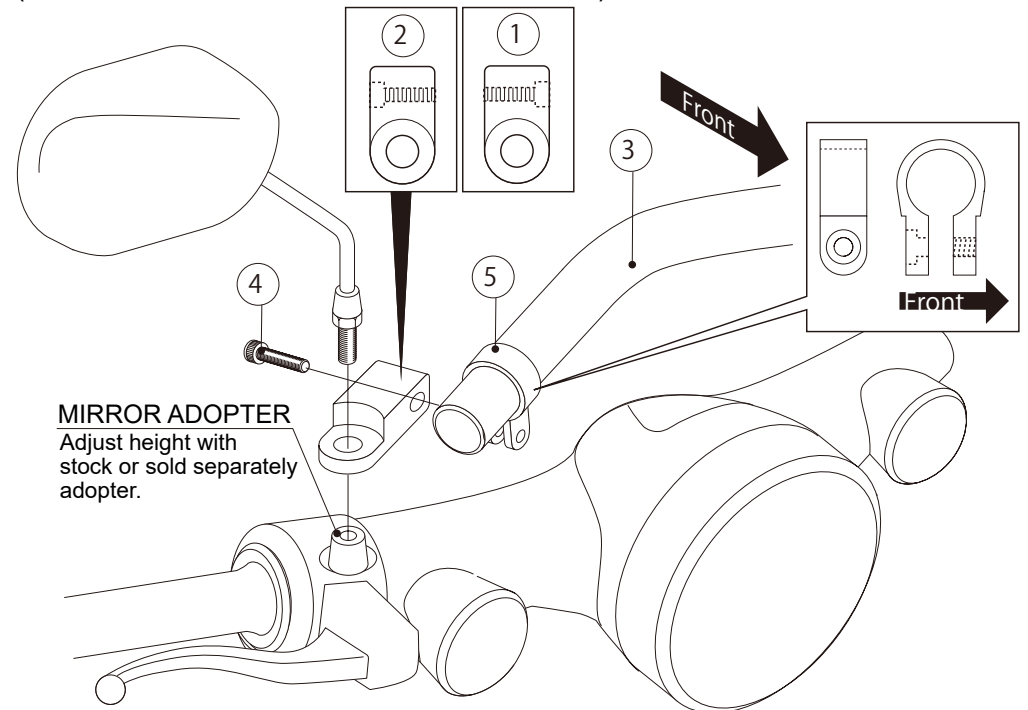

**MIRROR ADOPTER**  
Adjust height with stock or sold separately adopter.

210323 Y-N



3-8-13 NAGATA, HIGASHI-  
OSAKA, OSAKA, JAPAN  
<https://www.kitaco.co.jp/>