

TANDEM BACK REST BAR

CODE : 80-652-24160

APPLICATION : ADDRESS V125 L0

Thank you for purchasing Kitaco product. Read and understand the instruction before installing.

ATTENTION (MUST READ)

- This instruction sheet is for the instruction for genuine condition.
- This product is a parts for grab bar for tandem. Do not apply excessive force to grab bar. It might cause of breaking this product or surrounding parts.
- This product is designed and made exclusive for application vehicles, do not use other models. Do not modify the way which is not listed or it will cause damage and trouble.
- We are not responsible for violation of law or damages and accidents caused by assembling mistake and improper setting.
- Please ask authorized mechanic for assembling and setting.
- Refer to the manufacturer service manual when installation.
- Bolts and nuts may get loosen by engine vibration. Make sure not to loosen any bolts and nuts before driving.

PACKING LIST

FIG	NAME	QTY
-	PAD	× 1
-	BACK REST BAR	× 1
-	Φ 8 × 22 × T2mm WASHER	× 2
-	8mm FLANGE LOCK NUT	× 2

HOW TO INSTALL

Install pad and back rest bar with attached nut.
Remove helmet box and rear carrier or pillion rider handle, then install Kitaco back rest bar with reusing normal bolts to normal rear carrier or pillion rider handle installation point.
If there is a hard degradation like a blem, fatigue and wear etc on the reuse parts, please change to new ones.

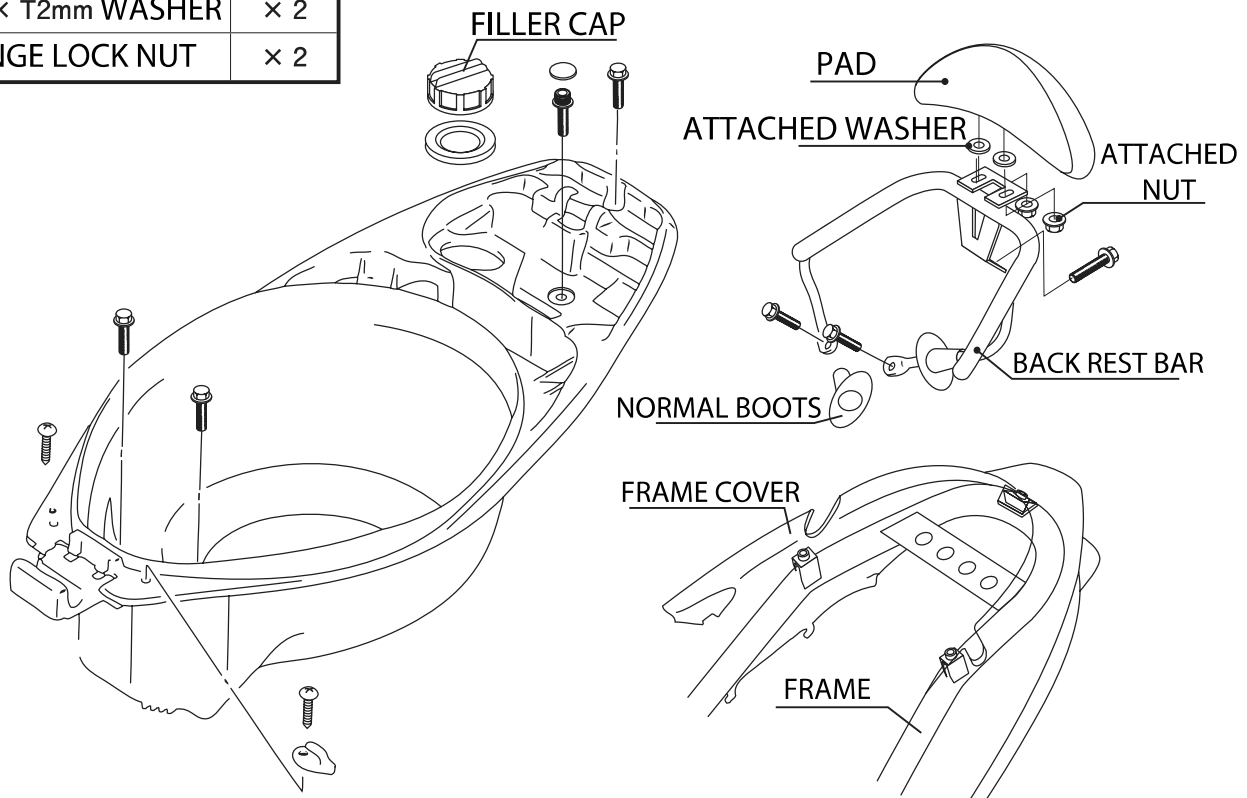

ATTENTION!

This product does not have enough toughness. Do not apply excessive force to tandem back rest when you use rope or tie to deliver the vehicle. Please use back rest as support.

製造元



220922 Y-N

〒 577-0015

3-8-13

KITACO NAGATA, HIGASHI-
株式会社 北工 OSAKA, OSAKA, JAPAN