



GRAB BAR		APPLICATION : SUPER CUB C125 (JA48/58)
CODE : (CHROME) : 80-653-13100		(BLACK) : 80-653-13101
REMARK : Cannot install with Kitaco helmet lock together.		
BE CAREFUL! With non-genuine rear shock, Kitaco GRAB BAR cannot be installed correctly because of different shape and size (especially upper part). 【Refer to the check point when you use not genuine rear shock.】		

Thank you for purchasing Kitaco product. Read and understand the instruction before installing.

ATTENTIONS (MUST READ)

- This instruction sheet is for the instruction for genuine condition.
- This product is designed and made exclusive for application vehicles, do not use other models. Do not modify the way which is not listed or it will cause damage and trouble.
- We are not responsible for violation of law or damages and accidents caused by assembling mistake and improper setting.
- Please ask authorized mechanic for assembling and setting.
- Refer to the manufacturer service manual when installation.
- Bolts and nuts may get loosen by engine vibration. Make sure not to loosen any bolts and nuts before driving.

 Do not apply excessive force when you use rope or tie to deliver the vehicle. It might damage this product or surrounding parts.

 Do not apply excessive force like turn the vehicle using this grab bar. This is helping tool for using center stand.

PACKING LIST				CHROME	BLACK	
FIGURE	NAME		CODE	QTY		REMARK
1	GRAB BAR	CHROME (STEEL)	653-1310090A	x1	-	
	END CAP	CHROME	998-0900005	x2	-	
1	GRAB BAR	BLACK (STEEL)	653-1310050A	-	x1	
	END CAP	BLACK	998-0900006	-	x2	
2	SPACER COLLAR(20x8.2xL40)	SILVER	653-1310003	x1	-	
		BLACK	653-1310004	-	x1	
3	CAP BOLT	M8x65	080-0500065	x1	x1	TORQUE 22 N·m (2.2 kgf·m)

CHECK POINTS WHEN USING NON GENUINE REAR SHOCK

If the rear shock shape and size (especially upper part) is different from genuine one, it might be unable to be installed correctly. Please check the points on right side.

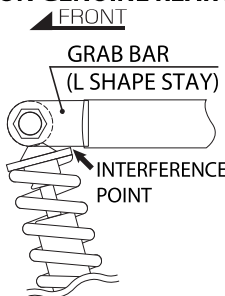

If the upper part width is different from genuine shock, the length of spacer collar excess or deficiency occurs, it cause apply excessive force to L shape stay that tighten together with upper part, then it cause of break. Therefore do not use it.

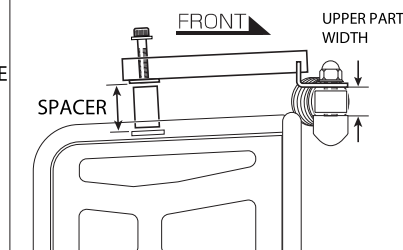

HOW TO INSTALL

- ※ If there is a hard degradation like a blem, fatigue and wear etc on the reuse parts, please change to new ones.
- Remove rear carrier genuine L side socket bolt(N4)/washer(N3), rear shock L side mounting nut(N1)/washer(N2).
- Tighten grab bar with attached bolt/washer(N3) and rear shock mounting nut(N1) together.
- ※ Do not use rear shock upper pivot washer(N2).

HOW TO TAKE CARE

Rust may occur depending on how to use. Especially, after riding under the rain or wash, wipe water completely and apply anti-rust.

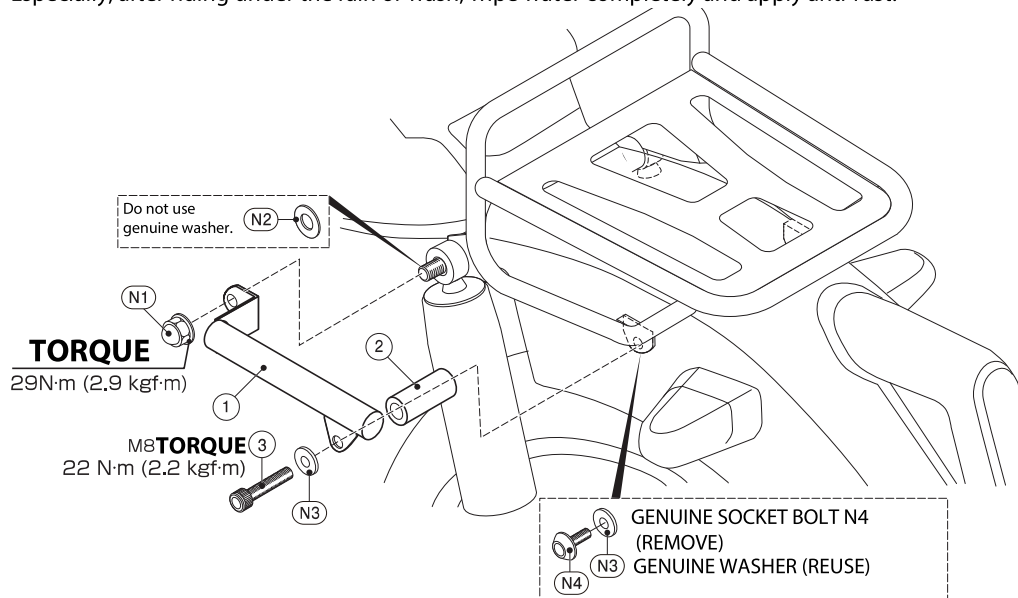

210416 M-T

〒 577-0015
3-8-13

KITACO NAGATA, HIGASHI-
株式会社 千七 OSAKA, OSAKA, JAPAN