

LED SHUTTLE BEAM KIT (2 lights type) UNDER PIPE MOUNTING TYPE No. 1/2		
CODE	(YELLOW) 800-1470430	(CLEAR) 800-1470480
APPLICATION	HUNTER CUB CT125 (JA55 / 65) ※Compatible for only japan models.	
REMARK	The products below take power from same points, therefore basically they cannot install together. In case using genuine option (grip heater, accessory socket), other option coupler, branch processing is required.	

●Thank you for purchasing Kitaco product. Read and understand the instruction before installing.

### ATTENTION (MUST READ)

- This product is for dress up parts. Do not use for other purposes.
- This product is designed and made exclusive for application vehicles, do not use other models. Do not modify the way which is not listed or it will cause damage and trouble.
- We are not responsible for violation of law or damages and accidents caused by assembling mistake and improper setting.
- Please ask authorized mechanic for assembling and setting.
- Refer to the manufacturer service manual when installation.
- This instruction sheet is for the instruction for genuine condition.
- ※Alumite products get discolored/rust for ages as well as how to use. Please understand when using.
- ※The lens have individual difference. This is tolerance, not defective product. Please understand before installing.

### [IMPORTANT] ATTENTION WHEN USING!

- This product may violate the law of the difference of amount of light and light image. Depending on where to install, it might violate safety standard. Please use this product only for dress up or auxiliary lighting.
- Condensation may occur because of temperature difference.
- This product is not completely waterproof. Please be careful when washing.
- Installing to a lot of vibration position, this product might not work perfectly, in the worst case, it cause of break. When installing, please do anti-vibration. Installing near engine, vibration and heat might cause of malfunction.
- When installed with a grip heater together consumes a lot of power, it may exceed the vehicle's allowable power consumption.
- ※We are not responsible for break because of heat and vibration. Be careful of it.

## SPECIFICATION

VOLTAGE	DC12V(AC alternating current cannot be used.) / 1 light power consumption (2 lights) : 10w (20w) / current consumption : 0.9A (1.8A)
LIGHTING	Spot beam
BRIGHTNESS	MAX 800 lumen / color temperature 6000 kelvin (clear)
HARNESS LENGTH	About 300mm
SPECIFICATION	Aluminum die-casting body / acrylic lens / stay•bolt set

PACKING LIST (Refer to the figure & illustration below)						
FIGURE	NAME	CODE	YELLOW	CLEAR	TORQUE	
1	LED SHUTTLE BEAM	YELLOW / 2 lights type CLEAR / 2 lights type	800-1470301YE 800-1470301CL	x2 -	- x2	
2	LED STAY		800-1470401	x2	x2	
3	POWER SWITCH STAY	For right side	800-1470402	x1	x1	
4	ON / OFF SWITCH	Push type	800-1470304	x1	x1	
5	POWER SUPPLY HARNESS	2 lights LED / CT125	800-1470403	x1	x1	
6	PAN HEAD (+) SMALL SCREW	M4x10	042-0503010	x1	x1	3N·m / 0.4kgf·m
7	CAP BOLT	M5x15	050-0500015	x4	x4	4.9N·m / 0.5kgf·m
8	CAP BOLT	M6x35	060-0500035	x2	x2	10N·m / 1.0kgf·m
9	BUTTON CAP BOLT	M6x15	060-0550015	x2	x2	10N·m / 1.0kgf·m
10	WASHER	6x13x1.0	090-0900006	x2	x2	
11	SPACER COLLAR	6.2x13xL8	093-0800007	x2	x2	
12	TIE WRAP (MS TIE)	100x2.5	700-9200100	x8	x8	

### HOW TO INSTALL

- Fix shuttle beam to under guard pipe with attached stay to favorite position.
- Adjust the degree of shuttle beam irradiation angle not to obstruct the view of oncoming vehicles.
- For the power supply of the shuttle beam, insert the harness from option 2P coupler inside head light case.
- (Refer to the wiring / connection illustration below.)
- Tighten shuttle beam power switch, stay and master cylinder holder together.
- Make sure not to loosen any parts before riding.

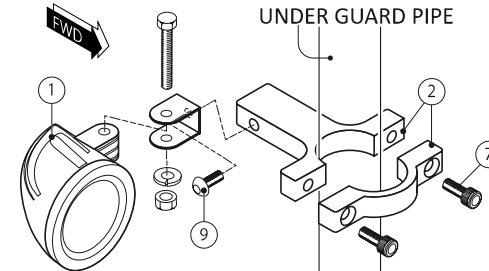

※Install as same as left side.

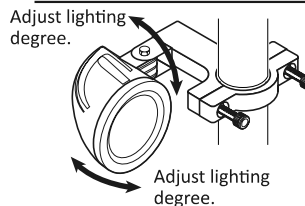
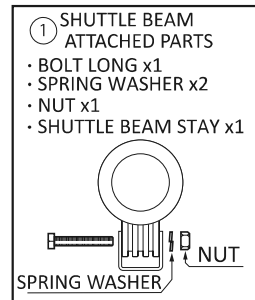

### INSTALLING ON / OFF SWITCH

Tightening order : Upper→Lower

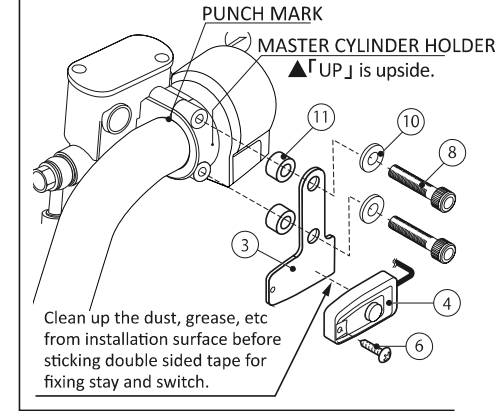

### WIRING ILLUSTRATION

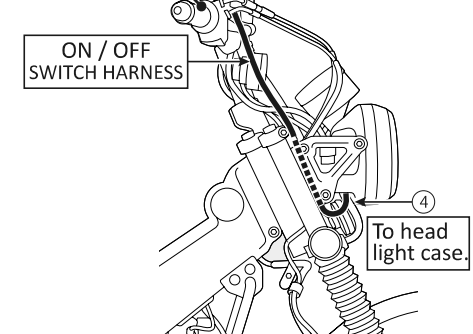

# LED SHUTTLE BEAM KIT (2 lights type) UNDER PIPE MOUNTING TYPE No. 2/2

CODE (YELLOW) 800-1470430 (CLEAR) 800-1470480

## WIRING ILLUSTRATION

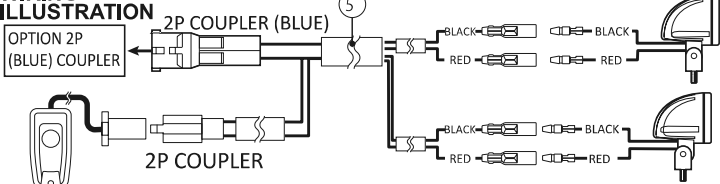

SHUTTLE BEAM ON / OFF SWITCH

POWER SUPPLY OUTLET	CONNECTOR / COUPLER POSITION
OPTION 2P (BLUE) COUPLER	Inside head light case. (waterproof process by dummy coupler) Remove dummy coupler to connect power supply harness⑤.

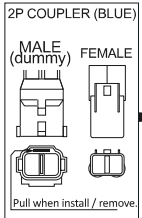

## WIRING ILLUSTRATION

**ATTENTION TO WIRING!**  
Be careful not to disconnect the harness sandwiched by covers and other parts not to prevent from handling, and fix with attached tie wrap.

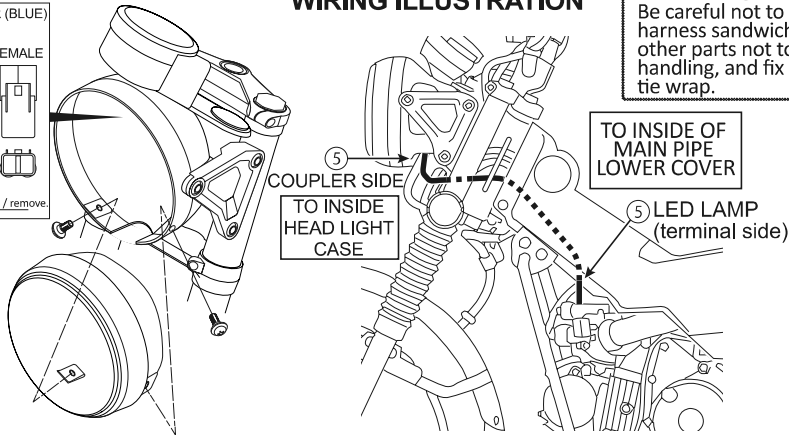

## REMOVING / INSTALLING OUTER COWLS

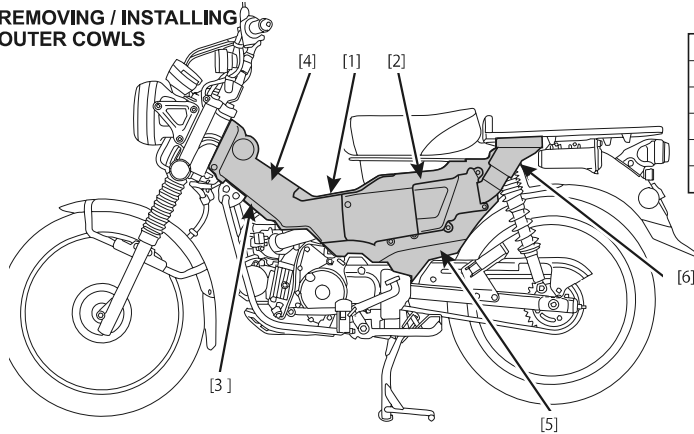

[1]	CENTER COVER
[2]	AIR CLEANER GARNISH / CASE
[3]	MAIN PIPE LOWER COVER
[4]	L. MAIN PIPE COVER
[5]	L. SIDE COVER
[6]	AIR CLEANER DUCT CAP

230308 M-T



3-8-13 NAGATA,  
HIGASHI-OSAKA,  
OSAKA, JAPAN